

# leva series tapware and showers

---

HYGIENIC, ERGONOMIC,  
STYLISH AND STRONG  
TWO LEVER LENGTHS



 **ENWARE**  
AUSTRALIA PTY LIMITED

[WWW.ENWARE.COM.AU](http://WWW.ENWARE.COM.AU)

# Leva's advanced design provides easy use and exceptional performance

**PERFECTLY SUITED TO HOSPITALS, AGED CARE FACILITIES AND FOOD APPLICATIONS, ENWARE'S LEVA RANGE COMBINES OUTSTANDING QUALITY WITH FUNCTIONAL, LEADING-EDGE DESIGN TO DELIVER SOPHISTICATED BENCH AND WALL MOUNTED LEVER TAPWARE.**

The range includes the popular LEVA 150 series. Designed specifically for hands-free operation, it features elbow lever activated tapware that helps reduce the risk of cross-contamination. For easy palm and wrist activated tapware, the LEVA 80 series delivers an extensive choice with greater control, particularly for arthritis sufferers. For accessible applications LEVA also delivers the benefits of easier reach, operation and control.

Highly reliable and durable, the range has been purpose built for longevity. It boasts a unique handle fixing, anti-rotating SBA, anti-rocking bushes and lock nut, and is made from heavy duty dezincification resistant brass for superior performance.

Advanced technology to ensure a consistent flow and water efficiency come standard with all Enware products. A proven range, the smart Leva series can effectively keep pace with the demands of any busy and hygienic environment. Should you require tailor-made tapware, Enware has the capability and expertise to meet your specific requirements.



## KEY FEATURES

- Extremely robust, the tapware is constructed from heavy-duty dezincification resistant brass
- Ergonomic and smart, leading-edge design
- Engineered for easy operation and control
- Clear identification on all lever handles for blue, yellow and red water control
- Unique handle fixing delivers superior strength and longevity
- Anti-rotating SBA minimises handle rotation
- Anti-rocking bushes and lock nut provide greater handle stability

## OPTIONS

### FINISHES:

Bright Chrome is standard. Optional Satin Chrome and Epoxy Powder Coating.

### INDICATORS:

Sets supplied with ● Blue ● Yellow and ● Red Indicator Rings.

### FLANGES:

Standard flange supplied allows for up to 15mm adjustment. Extended spindles 20, 25, 30 and 40mm can be ordered to allow for deeper recesses.

### SPOUT OPTIONS

Custom sizing is available refer to page 7.

### OUTLET OPTIONS

Aeration is supplied standard on wall and hob mounted spouts. Laminar flow option available in 6 or 8 lpm - specify when ordering.

### ¼ TURN CONTRA-ROTATING HANDLES WALL MOUNTED MIXING SET



### BENCH MOUNTED MIXING SET



Technical information refer to page 8.

## WATER EFFICIENCY

Enware Australia has used the performance criteria of:

- AS/NZS6400 - Water Efficient Products - Rating and Labelling
  - AS/NZS3718 - Tapware
  - AS/NZS3662 - Showers
- as the benchmark for our water efficient product performance.

The pressure compensating flow control technology included in Enware's product, ensures consistent flow rate delivery across the pressure band from 150 kpa - 500 kpa with minimal deviation.



WELS 3 Star (7.7 lpm) water efficiency rating supplied as standard.

Also available in 2 (9.1 lpm) 5 (5.6 lpm) Star ratings

WELS 3 Star (7.6 lpm) water efficiency rating supplied as standard.



AS/NZS 3718 WMKA 1583  
SAI Global

Enware Tapware is manufactured to the exacting WaterMark standard AS/NZS3718 and AS4020.

# LEVA 150 SERIES

## LEVA 150MM BASIN SET WITH SPC001 FIXED AERATED SPOUT

- Contra-rotating levers

Order Code:

**LEV150306** - Ceramic Disc  
**LJV150306** - Jumper Valve

WELS 3 Star (7.7 lpm) water efficiency rating supplied as standard  
 Also available in 2 (9.1 lpm) 5 (5.6 lpm) Star ratings

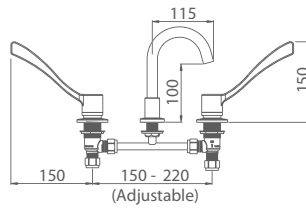

## LEVA 150MM TYPE 51 WALL MOUNTED MIXING SET WITH SPC020 SWIVEL AERATED SPOUT

- Contra-rotating levers

Order Code:

**LEV150402** - Ceramic Disc Fixed with 215mm (pictured)  
**LJV150402** - Jumper Valve Fixed with 215mm

**LEV150422** - Ceramic Disc Adjustable centres 355mm maximum  
**LJV150422** - Jumper Valve Adjustable centres 355mm maximum

WELS 3 Star (7.7 lpm) water efficiency rating supplied as standard  
 Also available in 2 (9.1 lpm) 5 (5.6 lpm) Star ratings

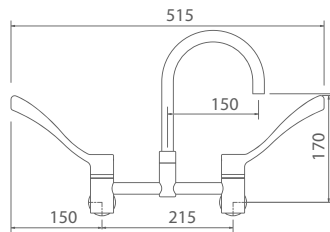

## LEVA 150MM WALL SET WITH FIXED SPOUT 250MM REACH

- Contra-rotating levers

Order Code:

**LEV150205** - Ceramic Disc  
**LJV150205** - Jumper Valve

WELS 3 Star (7.7 lpm) water efficiency rating supplied as standard  
 Also available in 2 (9.1 lpm) 5 (5.6 lpm) Star ratings

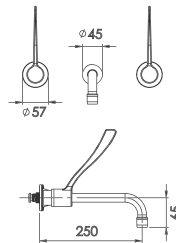

## LEVA 150MM RECESS WALL SET WITH SPC201 DELUXE FIXED AERATED BATH SPOUT

- Contra-rotating levers

Order Code:

**LEV150314** - Ceramic Disc  
**LJV150314** - Jumper Valve

WELS not applicable for baths. For basins specify desired flow rate when ordering.

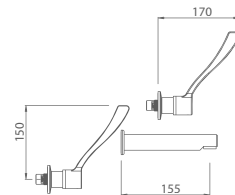

## LEVA 150MM RECESS WALL SET WITH SPC110 SWIVEL AERATED SPOUT

- Contra-rotating levers

Order Code:

**LEV150315** - Ceramic Disc  
**LJV150315** - Jumper Valve

WELS 3 Star (7.7 lpm) water efficiency rating supplied as standard  
 Also available in 2 (9.1 lpm) 5 (5.6 lpm) Star ratings

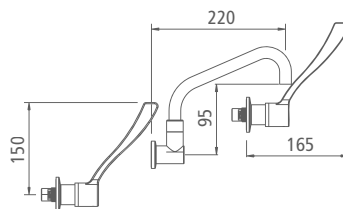

## LEVA 150MM SINK SET WITH SPC010 SWIVEL AERATED SPOUT

- Contra-rotating levers

Order Code:

**LEV150307** - Ceramic Disc  
**LJV150307** - Jumper Valve

WELS 3 Star (7.7 lpm) water efficiency rating supplied as standard  
 Also available in 2 (9.1 lpm) 5 (5.6 lpm) Star ratings

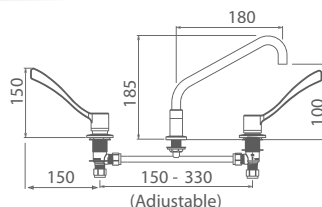

## LEVA 150MM TYPE 50 HOB MOUNTED MIXING SET WITH SPC020 SWIVEL AERATED SPOUT

- Contra-rotating levers

Order Code:

**LEV150401** - Ceramic Disc Fixed with 215mm (pictured)  
**LJV150401** - Jumper Valve Fixed with 215mm

**LEV150421** - Ceramic Disc Adjustable centres 355mm maximum  
**LJV150421** - Jumper Valve Adjustable centres 355mm maximum

WELS 3 Star (7.7 lpm) water efficiency rating supplied as standard  
 Also available in 2 (9.1 lpm) 5 (5.6 lpm) Star ratings

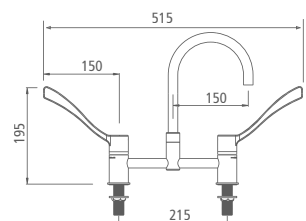

# LEVA 150 SERIES

## LEVA 150MM PILLAR COCK 15MM

Order Code:

**LEV150302** - Ceramic Disc Specify Cold, Warm or Hot when ordering  
**LJV150302** - Jumper Valve Specify Cold, Warm or Hot when ordering

WELS 3 Star (7.7 lpm) water efficiency rating supplied as standard  
 Also available in 2 (9.1 lpm) 5 (5.6 lpm) Star ratings

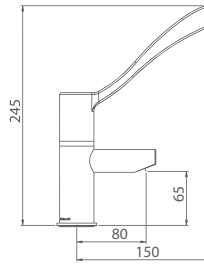

## LEVA 150MM BIB COCK - FEMALE 15MM

Order Code:

**LEV150301F** - Ceramic Disc Specify Cold, Warm or Hot when ordering  
**LJV150301F** - Jumper Valve Specify Cold, Warm or Hot when ordering

WELS 3 Star (7.7 lpm) water efficiency rating supplied as standard  
 Also available in 2 (9.1 lpm) 5 (5.6 lpm) Star ratings

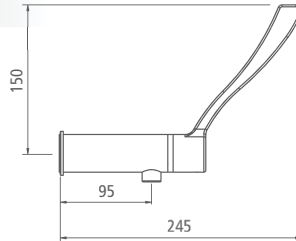

## LEVA 150MM TYPE 56 WALL MOUNTED MIXING SET

- Contra-rotating levers

Order Code:

**LEV150420** - Ceramic Disc  
**LJV150420** - Jumper Valve

WELS 3 Star (7.7 lpm) water efficiency rating supplied as standard  
 Also available in 2 (9.1 lpm) 5 (5.6 lpm) Star ratings  
 \*For alternate spout lengths contact your Enware representative

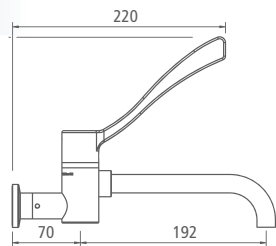

## LEVA 150MM RECESS ADAPTOR

- Extended spindle options available

Order Code:

**LEV150308** - Ceramic Disc Specify Cold, Warm or Hot when ordering  
**LJV150308** - Jumper Valve Specify Cold, Warm or Hot when ordering

\*For shower head and outlet options see pg 7

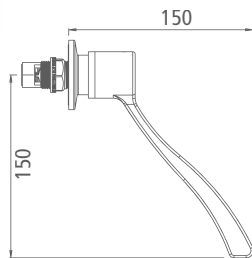

## LEVA 150MM RECESS WALL SET HAND HELD SHOWER AND 1.5M HOSE WITH 900MM STAINLESS STEEL GRAB RAIL AND ADJUSTABLE HEIGHT SHOWER HEAD HOLDER

- Contra-rotating levers
- Alternate rail lengths – 300 or 600mm

Order Code:

**LEV150364** - Ceramic Disc  
**LJV150364** - Jumper Valve

WELS 3 Star (7.7 lpm) water efficiency rating supplied as standard  
 \*For shower and outlet options see pg 7

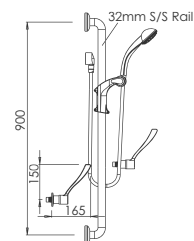

## LEVA 150MM WASHING MACHINE TAP

Order Code:

**LEV150313** - Ceramic Disc Specify Cold, Warm or Hot when ordering  
**LJV150313** - Jumper Valve Specify Cold, Warm or Hot when ordering

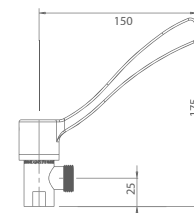

## LEVA 150MM RECESS WALL SET WITH SP251 EXTENDABLE LAUNDRY ARM

- Contra-rotating levers

Order Code:

**LEV150347** - Ceramic Disc  
**LJV150347** - Jumper Valve

WELS 3 Star (7.7 lpm) water efficiency rating supplied as standard  
 Also available in 2 (9.1 lpm) 5 (5.6 lpm) Star ratings

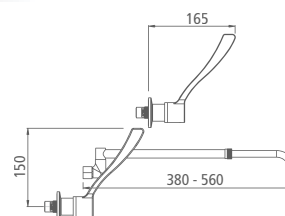

# LEVA 80 SERIES

## LEVA 80MM BASIN SET WITH SPC001 FIXED AERATED SPOUT

- Contra-rotating levers

Order Code:

**LEV80306** - Ceramic Disc

**LJV80306** - Jumper Valve

WELS 3 Star (7.7 lpm) water efficiency rating supplied as standard

Also available in 2 (9.1 lpm) 5 (5.6 lpm) Star ratings

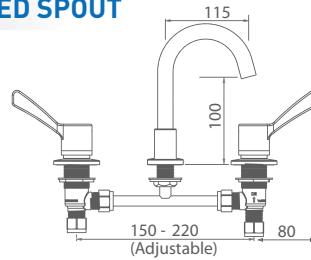

## LEVA 80MM RECESS WALL SET WITH SPC110 SWIVEL AERATED SPOUT

- Contra-rotating levers

Order Code:

**LEV80315** - Ceramic Disc

**LJV80315** - Jumper Valve

WELS 3 Star (7.7 lpm) water efficiency rating supplied as standard

Also available in 2 (9.1 lpm) 5 (5.6 lpm) Star ratings

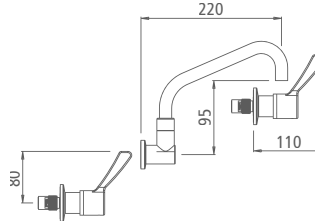

## LEVA 80MM SINK SET WITH SPC010 SWIVEL AERATED SPOUT

- Contra-rotating levers

Order Code:

**LEV80307** - Ceramic Disc

**LJV80307** - Jumper Valve

WELS 3 Star (7.7 lpm) water efficiency rating supplied as standard

Also available in 2 (9.1 lpm) 5 (5.6 lpm) Star ratings

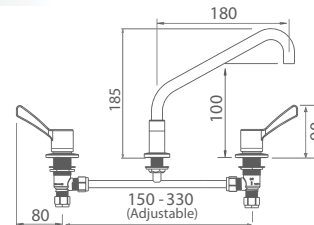

## LEVA 80MM PILLAR COCK 15MM

Order Code:

**LEV80302** - Ceramic Disc Specify Cold, Warm or Hot when ordering

**LJV80302** - Jumper Valve Specify Cold, Warm or Hot when ordering

WELS 3 Star (7.7 lpm) water efficiency rating supplied as standard

Also available in 2 (9.1 lpm) 5 (5.6 lpm) Star ratings

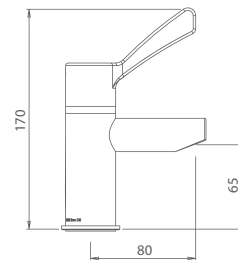

## LEVA 80MM TYPE 50 HOB MOUNTED MIXING SET WITH SPC020 SWIVEL AERATED SPOUT

- Contra-rotating levers

Order Code:

**LEV80401** - Ceramic Disc

**LJV80401** - Jumper Valve

WELS 3 Star (7.7 lpm) water efficiency rating supplied as standard

Also available in 2 (9.1 lpm) 5 (5.6 lpm) Star ratings

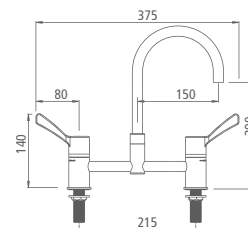

## LEVA 80MM TYPE 51 WALL MOUNTED MIXING SET WITH SPC020 SWIVEL AERATED SPOUT

- Contra-rotating levers

Order Code:

**LEV80402** - Ceramic Disc

**LJV80402** - Jumper Valve

WELS 3 Star (7.7 lpm) water efficiency rating supplied as standard

Also available in 2 (9.1 lpm) 5 (5.6 lpm) Star ratings

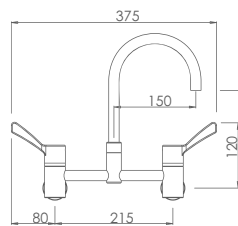

## LEVA 80MM RECESS WALL SET WITH SPC201 DELUXE FIXED AERATED BATH SPOUT

- Contra-rotating levers

Order Code:

**LEV80314** - Ceramic Disc

**LJV80314** - Jumper Valve

WELS not applicable for bath

For basins please specify desired flow rate when ordering

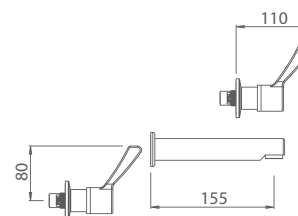

# LEVA 80 SERIES

## LEVA 80MM BIB COCK - FEMALE 15MM

Order Code:

**LEV80301F** - Ceramic Disc Specify Cold, Warm or Hot when ordering  
**LJV80301F** - Jumper Valve Specify Cold, Warm or Hot when ordering

WELS 3 Star (7.7 lpm) water efficiency rating supplied as standard  
 Also available in 2 (9.1 lpm) 5 (5.6 lpm) Star ratings

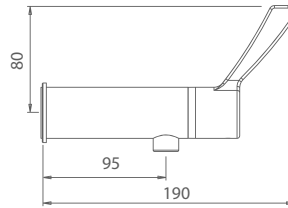

## LEVA 80MM RECESS ADAPTOR

- Extended spindle option available

Order Code:

**LEV80308** - Ceramic Disc Specify Cold, Warm or Hot when ordering  
**LJV80308** - Jumper Valve Specify Cold, Warm or Hot when ordering

\*For spout, shower head and outlet options see pg 7

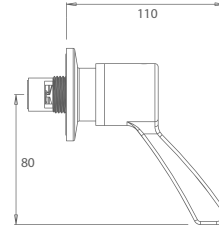

## LEVA 80MM RECESS WALL SET HAND HELD SHOWER AND 1.5M HOSE WITH 900MM STAINLESS STEEL GRAB RAIL AND ADJUSTABLE HEIGHT SHOWER HEAD HOLDER

- Contra-rotating levers
- Alternate rail lengths available – 300 or 600mm

Order Code:

**LEV80364** - Ceramic Disc  
**LJV80364** - Jumper Valve

WELS 3 Star (7.7 lpm) water efficiency rating supplied as standard  
 \*For shower and outlet options see pg 7

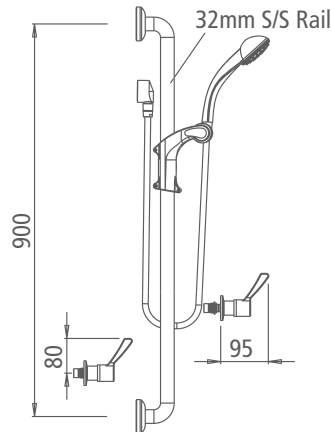

## LEVA 80MM RECESS WALL SET WITH SP262 DELUXE SHOWER ROSE

- Contra-rotating levers

Order Code:

**LEV80316** - Ceramic Disc  
**LJV80316** - Jumper Valve

WELS 3 Star (7.7 lpm) water efficiency rating supplied as standard

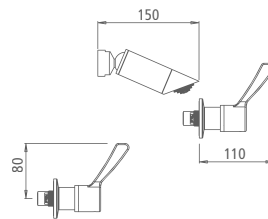

## LEVA 80MM WASHING MACHINE TAP

Order Code:

**LEV80313** - Ceramic Disc Specify Cold, Warm or Hot when ordering  
**LJV80313** - Jumper Valve Specify Cold, Warm or Hot when ordering

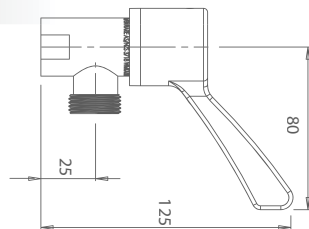

## LEVA 80MM RECESS WALL SET WITH SP251 EXTENDABLE LAUNDRY ARM

- Contra-rotating levers

Order Code:

**LEV80347** - Ceramic Disc  
**LJV80347** - Jumper Valve

WELS 3 Star (7.7 lpm) water efficiency rating supplied as standard  
 Also available in 2 (9.1 lpm) 5 (5.6 lpm) Star ratings

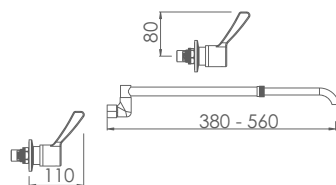

# SPECIFY AN OUTLET SIZE AND SHAPE TO SUIT YOUR APPLICATION

Enware has a wide range of spout options available. Below are a selection of the most common shapes and sizes. For more spout and outlet options please refer to Enware's Outlets brochure or contact your Enware representative. We can also customise tapware to meet your needs. To order your Leva tapware please specify your preferred spout code and description.

## BENCH MOUNTED OPTIONS

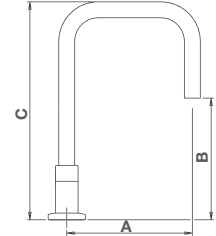
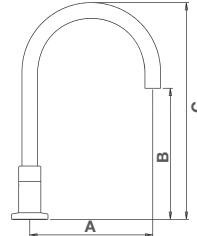
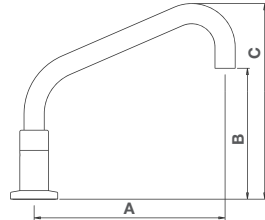
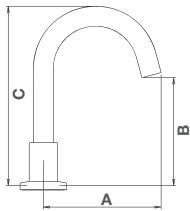

| CACHE CURVED BASIN SPOUT        | CACHE HOB STANDARD SWIVEL SPOUT | CACHE HOB CURVED SWIVEL SPOUT | CACHE HOB SQUARE SWIVEL SPOUT |
|---------------------------------|---------------------------------|-------------------------------|-------------------------------|
| A B C                           | A B C                           | A B C                         | A B C                         |
| SP001 Fixed Outlet 115 100 175  | SPC010 180 100 185              | SPC020 150 150 265            | SPC040 150 145 260            |
| SP002 Swivel Outlet 115 120 195 | SPC011 230 145 225              | SPC021 150 235 350            | SPC045* * * *                 |
|                                 | SPC012 300 165 245              | SPC025* 150 * *               |                               |
|                                 | SPC015* * * *                   | SPC026 200 125 265            |                               |
|                                 |                                 | SPC027* 200 * *               |                               |

## WALL MOUNTED OPTIONS

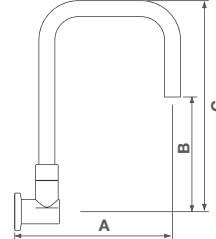
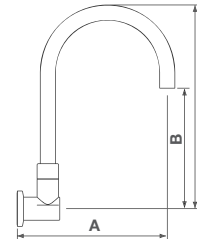
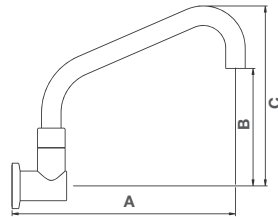
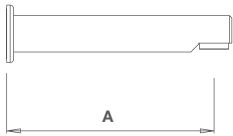

| CACHE WALL FIXED BATH SPOUT | CACHE WALL STANDARD SWIVEL SPOUT | CACHE WALL CURVED SWIVEL SPOUT | CACHE WALL SQUARE SWIVEL SPOUT |
|-----------------------------|----------------------------------|--------------------------------|--------------------------------|
| A B C                       | A B C                            | A B C                          | A B C                          |
| SPC201 155 - -              | SPC110 220 95 175                | SPC120 190 145 225             | SPC140 190 135 250             |
| SPC202 180 - -              | SPC111 270 135 215               | SPC121 190 225 340             | SPC145* * * *                  |
| SPC203 205 - -              | SPC112 340 160 235               | SPC125* 190 * *                |                                |
| SPC205* * - -               | SPC115* * * *                    | SPC126 240 115 260             |                                |
|                             |                                  | SPC127* 250 * *                |                                |

*\* Indicates custom size products. There are limitations and additional costs, please check with your Enware representative.*

## SHOWERS

Enware's extensive range of commercial and specialist tapware incorporates a range of water efficient showers with anti vandal options, hand held showers and trigger activated shampoo sprays suitable for commercial amenities, hospitals, hotels, sporting facilities, beaches and public areas.

| HAND HELD SHOWER AND WALL BRACKET - 1500MM HOSE | SLIDING HAND HELD SHOWER AND WALL BAR - 1500MM HOSE | HAND HELD SHOWER AND 32MM GRAB RAIL - 1500MM HOSE   | DELUXE SHOWER   |
|---|---|---|---|
| Order Code: <b>SP272</b>                        | Order Code: <b>SP273</b>                            | Order Code: <b>SGR023</b>   | Order Code: <b>SP262</b>                                  |
|   |   | <p>- 900mm Length supplied standard. Optional 300mm or 600mm also available, specify when ordering.</p> |   |
|   |   |   | <b>ALL DIRECTIONAL SHOWER</b><br>Order Code: <b>SP263</b> |

# TECHNICAL INFORMATION

| VALVING OPTIONS:                        | 1/4 TURN CERAMIC DISC | 1/4 TURN RISING JUMPER VALVE |
|---|-----------------------|------------------------------|
| Maximum Working Pressure (AS/NZS 3500): | 500 kPa               | 500 kPa                      |
| Minimum-Maximum Rated Static Pressure:  | 50-800 kPa            | 30-1200 kPa                  |
| Maximum Working Temperature*:           | 85°C                  | 95°C                         |

Enware products are to be installed in accordance with AS/NZS3500.

\*Heated Water Supply AS/NZS 3500.4: For all sanitary fixtures used primarily for personal hygiene purposes are to deliver heated water not exceeding:  
**a) 45°C** for early childhood centres, primary and secondary schools and nursing homes or similar facilities for young, aged care, sick people with disabilities (43.5°C - NSW Code of Plumbing Practice)

**b) 50°C** in all other building

NOTE: Enware Australia advises -

1. Due to ongoing Research and Development, specifications may change without notice.
2. Component specifications may change on some export models.

## HANDLE DIMENSIONS AND SPARE PARTS

NOTE: Contra-Rotating handles are standard on all mixing sets - refer to page 2 for diagram.

### CERAMIC DISC

#### LEVA 150 HANDLE AND IDENTIFICATION RING

**LEV150378** 150mm Lever suits Ceramic Disc

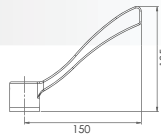

#### LEVA 80 HANDLE AND IDENTIFICATION RING

- For recess adaptors refer to 308 codes
- LEV80378** 80mm Lever suits Ceramic Disc

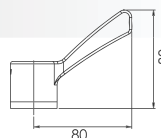

#### LEVA 150 BASIN/SINK TOP ASSEMBLY

- Specify for cold, warm or hot when ordering
- LEV150391** 150mm Lever - 1/4 Turn Ceramic Disc

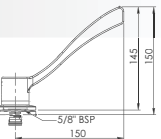

#### LEVA 80MM BASIN/SINK TOP ASSEMBLY

- Specify for cold, warm or hot when ordering
- LEV80391** 80mm Lever - 1/4 Turn Ceramic Disc

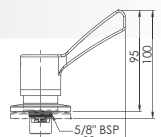

### JUMPER VALVE

#### LEVA 150 HANDLE AND IDENTIFICATION RING

**LJV150378** 150mm Lever suits Jumper Valve

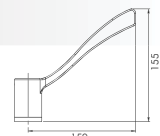

#### LEVA 80 HANDLE AND IDENTIFICATION RING

- For recess adaptors refer to 308 codes
- LJV80378** 80mm Lever suits Jumper Valve

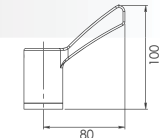

#### LEVA 150 BASIN/SINK TOP ASSEMBLY

- Specify for cold, warm or hot when ordering
- LJV150391** 150mm Lever - 1/4 Turn Jumper Valve

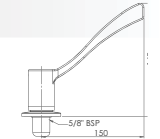

#### LEVA 80MM BASIN/SINK TOP ASSEMBLY

- Specify for cold, warm or hot when ordering
- LJV80391** 80mm Lever - 1/4 Turn Jumper Valve

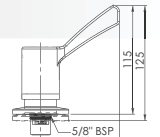

## ENWARE IN BRIEF

Enware is a world-leading Australian designer and manufacturer of quality specialist commercial tapware solutions and safety systems.

Since inception in 1937, Enware Australia has grown significantly. Today, Enware has offices located around the country and is represented in major regions throughout the world including Asia, the Pacific, the Middle East and Europe. As a global leader of specialist tapware and safety systems, Enware offers a more extensive range than any other company on the market.

## SOPHISTICATED MANUFACTURING DELIVERS PREMIUM QUALITY

To develop our innovative specialist products we use extensive market research, our technical know-how and experience. Our precision manufacturing plants ensure the quality and reliability for which Enware products are renowned, with our continued commitment to meeting Australian and international standards.

We strive to exceed your expectations by providing durable, dependable products that offer water efficient solutions and are designed and manufactured in an environmentally caring manner.

SPECIALIST  
PLUMBING SOLUTIONS

ADAPTABLE WORK  
& LIVING SOLUTIONS

ENVIRONMENTAL, HEALTH  
& SAFETY SOLUTIONS

STAINLESS STEEL  
WASHROOM SYSTEMS



ADDRESS: 9 Endeavour Road, Caringbah NSW 2229 Australia  
 POSTAL ADDRESS: P.O. Box 2545, Taren Point NSW 2229 Australia  
 PHONE: 61 2 9525 9511      FAX: 61 2 9525 9536  
 1300 369 273 (AUS)    WWW.ENWARE.COM.AU    INFO@ENWARE.COM.AU

