



water chillers

NATURE'S WATER:
ALWAYS FRESH
AND CHILLED

- water chillers

water chillers

Nature's water on demand, always fresh and chilled.

Enware's Waterware range incorporates proven water technology with water chillers that make it all so easy — in a choice of attractive free-standing or under-counter models that deliver quality water in a range of capacities.



attractive, free-standing water chillers

Clever and practical free-standing chillers deliver cool, fresh, mains pressure drinking water at the press of a button.

- Up to 18 litres chilled water per hour
- Hygienic, polished stainless steel tops designed for rapid draining
- Adjustable levelling feet
- Stainless steel storage tank
- FDA approved internal pipework
- Environmentally friendly R134A refrigerant



Order Code:
DFSA120



Order Code:
DFSA121



Order Code:
DFSA100



Order Code:
DFSA101

options

- Carafe/glass filler
- Carbon filter
- Brushed stainless or Powder coated finish

technical information

Model No.	Description	Finish Side Panel	Flow Rate (l/h)	Compressor Size (hp)	Condenser	Refrigerant	Storage Tank (litres)	Dimensions (mm)	Mass (kg)
DFSA100	Free Standing Bubbler	Powder Coat	18	1/6	Dual	R134A	4	940H x 330W x 320D	28
DFSA101	Free Standing Bubbler	Stainless	18	1/6	Dual	R134A	4	940H x 330W x 320D	28
DFSA120	Free Standing Bubbler + Carafe	Powder Coat	18	1/6	Dual	R134A	4	940H x 330W x 320D	28
DFSA121	Free Standing Bubbler + Carafe	Stainless	18	1/6	Dual	R134A	4	940H x 330W x 320D	28

Enware products are to be installed in accordance with AS/NZS3500.

Product details in this guide are indicative only and may change without notice.

waterware water chiller accessories

CARAFE/GLASS FILLER KIT (pictured)

- Suits all under counter and multi-point models
- Includes 1.5m tubing with 9/16" brass compression fittings

Order Code:
DFS010



CARBON FILTER

- Optional — suits all models

Order Code:
DFS002F

PUSH BUTTON BUBBLER OUTLET (pictured)

- For Multi-point Chillers or as a spare part for free standing chillers

Order Code:
BUB290

BUBBLER OUTLET REPLACEMENT CARTRIDGE

- Fits BUB290 bubbler outlet

Order Code:
BUB294



convenient under counter water chiller

Creates a clever use of space with the Waterware Under Counter Water Chiller. This unit hides neatly away and delivers pure refreshment all day long.

- Provides up to 16 litres of mains pressure, chilled water per hour Stainless steel storage tank and pipework
- Louvred front panel for ventilation
- Easy access for maintenance
- Environmentally friendly R134A refrigerant
- Optional carbon filter for cleaner water

Order Code:
DUC200

**See Waterware Water Chiller Accessories for bubbler and carafe/glass filler outlets, which are sold separately. For more outlet choices please contact Enware.*



Enware products are to be installed in accordance with AS/NZS3500.

technical information

Model No.	Description	Finish Side Panel	Flow Rate (l/hp)	Compressor Size (hp)	Condenser	Refrigerant	Storage Tank (litres)	Dimensions (mm)	Mass (kg)
DUC200	Under Counter	Powder Coat	16	1/6	Dual	R134A	3	310H x 420W x 300D	28

practical remote multi-point water chiller

For higher demand applications choose the Waterware Remote Multi-Point Water Chiller. This unit is capable of servicing multiple outlets.

- Provides up to 96 litres of mains pressure, chilled water per hour Stainless steel storage tank and pipework
- Louvred panels for ventilation
- Side panel access for easy maintenance
- Environmentally friendly R134A refrigerant
- Optional carbon filter for cleaner water

Order Code:

DRC100

**See Waterware Water Chiller Accessories for bubbler and carafe/glass filler outlets, which are sold separately. For more outlet choices please contact Enware.*



technical information

Model No.	Description	Finish Side Panel	Flow Rate (l/hp)	Compressor Size (hp)	Condenser	Refrigerant	Storage Tank (litres)	Dimensions (mm)	Mass (kg)
DRC100	Remote Multi-Point	Powder Coat	96	1/2	Aluminium Finned	R404A	65	885H x 510D x 710W	62

Enware products are to be installed in accordance with AS/NZS3500.

barrier free drinking fountains

Colour coding for media identification on handles, buttons and outlets follow the recommendations of DIN EN 13792. Tough, corrosion-resistant, coloured powder-coating makes the range suitable for the harshest laboratory environment. Specify the media type when ordering for correct colour identification and lubricant.



DELUXE

- Wall Mounted Drinking Fountain

Order Code:
CDF300D



DELUXE

- Hi-Lo Wall Mounted Drinking Fountain

Order Code:
CDF320D



ECONOMICAL

- Accessible Wall Mounted

Order Code:
CDF330D



ECONOMICAL

- Accessible Hi-Lo Wall Mounted

Order Code:
CDF340D

chilled versions

Provide the comfort of chilled water from the convenience of our wall mounted barrier free drinking fountains.

- Provides up to 30 litres/hour of mains pressure chilled water.
- Stainless steel storage tank and pipework
- Louvered front ventilation panel
- Easy access for maintenance
- Environmentally friendly R134A refrigerant
- Optional carbon filter available



technical information

DRINKING FOUNTAIN

Inlet Connection	3/8" O.D. compression fitting
Waste Elbow Outlet	1-¼ O.D. tube
Minimum Supply Line Size	½" with 200-500kPa flow pressure

CHILLER

Flow Rate	30 lph
Refrigerant	R134A
Power Supply	240V/50Hz
Dimensions	43H x 338W x 261D

RELATED PRODUCTS

Spring Action Tapware and Bubblers — Page 64

**Free Standing Chiller with Bubbler Outlet
— Powder Coated**

DFSA100

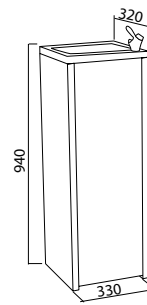

**Free Standing Chiller with Bubbler Outlet
— Stainless Steel**

DFSA101

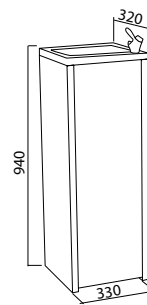

**Free Standing Chiller with Bubbler and Carafe Filler
— Powder Coated**

DFSA120

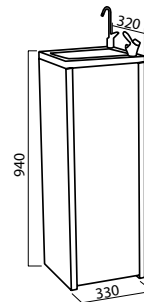

**Free Standing Chiller with Bubbler and Carafe Filler
— Stainless Steel**

DFSA121

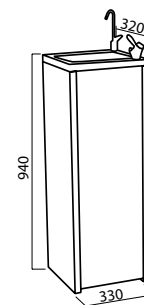

Remote Multi-Point Water Chiller

DRC100

96 Litres Per Hour

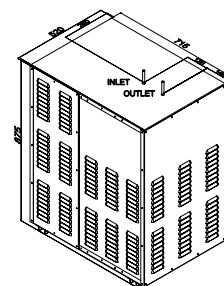

Under Counter Water Chiller

DUC200

16 Litres Per Hour

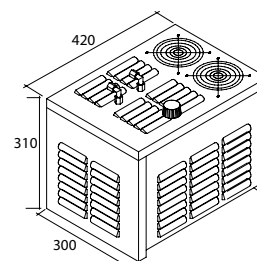

Heavy Duty Glass Filler

BUB281 Western Australian Model — 9/16" Inlet
 BUB281C To suit Waterware Chillers — 7/16" Inlet

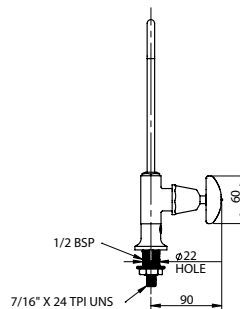

Type 62 Glass Filler Wall Mounted

BUB286

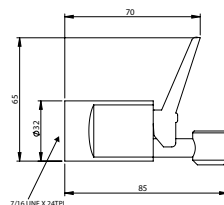

Type 61 Bubbler

BUB290 Outlet (Button Action)
 BUB290B Outlet (Button Action) 15mm Male Inlet

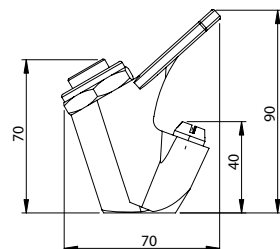

Type 62 Glass Filler with Lever Handle

BUB292 Complete — Hob Mounting

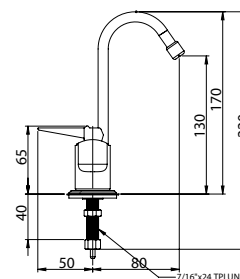

Barrier Free Wall Mounted Deluxe Drinking Fountain with Chiller

CDF300DC

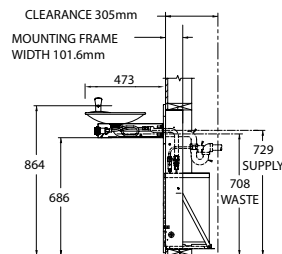

Barrier Free Hi-Lo Wall Mounted Deluxe Drinking Fountain with Chiller

CDF320DC

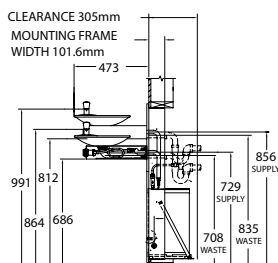

Barrier Free Wall Mounted Drinking Fountain with Chiller

CDF330DC

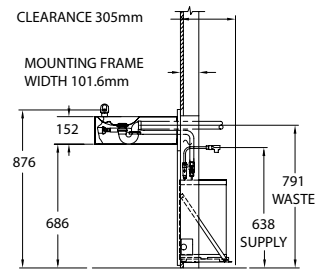

Barrier Free Hi-Lo Wall Mounted Drinking Fountain with Chiller

CDF340DC

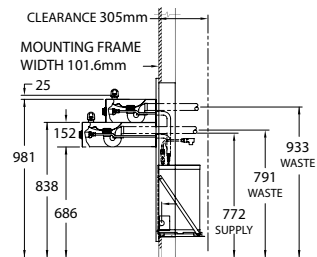

Pure Water Filter

DFS001F

Carbon Filter

DFS002F

Carafe Filler Kit

DFS010

Type 61 (BUB290) Spare Parts

BUB287	Spanner
BUB288	Inlet Screen and Washer
BUB294	Cartridge
BUB295	Retaining Nut
BUB296	Push Button
BUB297	Hex Cover Nut
BUB298	Spout Assembly Kit

**Glass Filler Spout Only 15mm To Suit BUB281**

BUB282

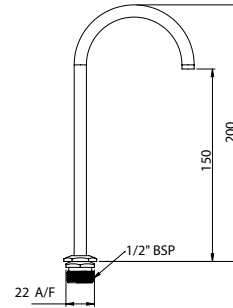
**Type 62 Handle Kit**

BUB285

