

PLAZA BASIN/SINK TOP ASSEMBLY

Key features



PRODUCTS

Product code	Line description
PZQ391	1/2 Turn Ceramic Disc

DIMENSIONS

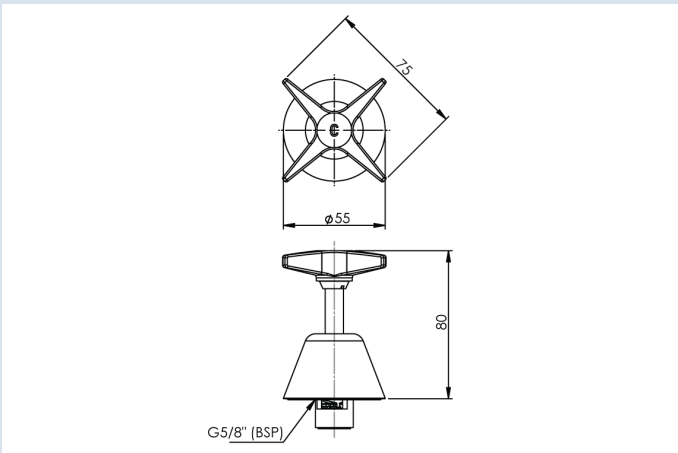

TECHNICAL INFORMATION

Ceramic Disc Minimum-Maximum Working Pressure (AS/NZS 3500)*	50-500kPa
Ceramic Disc Maximum Static Pressure	800kPa
Ceramic Disc Maximum Working Temperature*	85 C
Jumper Valve Minimum-Maximum Working Pressure (AS/NZS 3500)*	30-500kPa
Jumper Valve Maximum Static Pressure	1200kPa
Jumper Valve Maximum Working Temperature*	95 C

* Enware products are to be installed in accordance with the Plumbing Code of Australia and AS/NZS3500. NOTE: Enware Australia advises: 1. Due to ongoing Research and Development, specifications may change without notice. 2. Component specifications may change on some export models.