

# Amara Sink Mixer with Extended Handle

The Amara single lever mixer range has been designed for health, aged care as well as public spaces.

When it comes to transitioning from the familiar home environment to an unfamiliar aged care environment, it can be challenging. The Amara range of single lever mixers brings a sense of style to the independent living or aged care accommodation space helping residents feel more comfortable about their new home. Functionality that is familiar to the resident in the ensuite is of equal importance to style.

Amara range - a blend of familiarity, style and function.



## KEY FEATURES

- Highly visible colour indicators
- Easy to use, easy to hold handle design
- Metal chrome plated handle
- Easy to operate ceramic disc cartridge
- Flexibility is provided to the facility by the inclusion of handles with blue/red and blue/yellow indicators
- Lead Free brass
- Neoperl supply hoses - robust and highly flexible
- Includes 3 Star WELS (8 lpm) aerator (fitted), 5 Star (5.5 lpm) and 6 Star WELS (3 lpm) aerators (supplied in carton)
- Full swivel spout

## PRODUCT CODE

AMA307D

Amara Sink Mixer with Extended Handle



Products are to be installed in accordance with the Plumbing Code of Australia and AS/NZS3500. Reference should also be made to the Australasian Health Facility Guidelines (AHFG), ABCB and Local Government regulations when considering the choice of, and the installation of these products.

This product is compliant with the Lead Free requirements of NCC Volume Three.

Due to ongoing Research and Development, specifications may change without notice. Component specifications may change on some export models.

Refer to warranty statement for warranty details - [www.enware.com.au/warranty](http://www.enware.com.au/warranty).

# Amara Sink Mixer with Extended Handle

## TECHNICAL DATA

Maximum Recommended Temperature	70°C
Minimum Recommended Pressure	100 kPa
Maximum Recommended Pressure	800 kPa
Inlet Connection	1/2" BSP

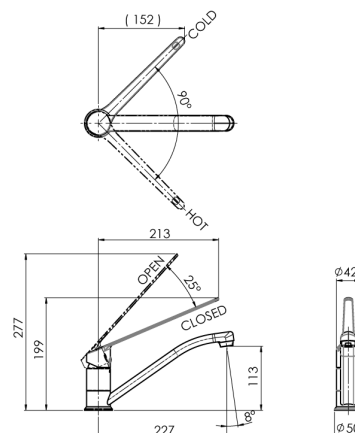

Blue/Red and Blue/Yellow colour indicator handles included

## SPARE PARTS

AMAS-013	Spare Parts: Extended Lever for Amara Sink Mixer (Red/Blue) with grub screw and handle plug
AMAS-014	Extended Lever for Amara Sink Mixer (Yellow/Blue) with grub screw and handle plug
AMAS-005	Handle grub screw and handle plug (pack of 10) suit Amara
AMAS-006	Cover Cap and Cartridge Retaining Nut suit Amara
AMAS-007	Cartridge 35mm suit AMA307/307D/308/309
AMAS-015	Aerator 3 star 7.7 L/min (40.1054.000)
AMAS-022	Aerator 6 star 3.8 L/min (40.1058.000)
AMAS-023	Aerator 5 star - 5.5 L/min (40.1052.000)
AMAS-016	Flange base for AMA307 sink mixer
AMAS-017	Seals kit for spout suit AMA307 sink mixer
AMAS-010	Fixing kit Amara
AMAS-011	Inlet hose - hot 450 x M10 DN6
AMAS-012	Inlet hose - cold 450 x M10 DN6