

TMV Cabinet Security Lid Assembly

ATMSSEC-350
ATMSSEC-430

ASSEMBLY INSTRUCTIONS

1. Attach adjustable brackets to TMV cabinet using screws supplied on the cabinet.
2. Attach lid to the adjustable brackets using Torx screws supplied.

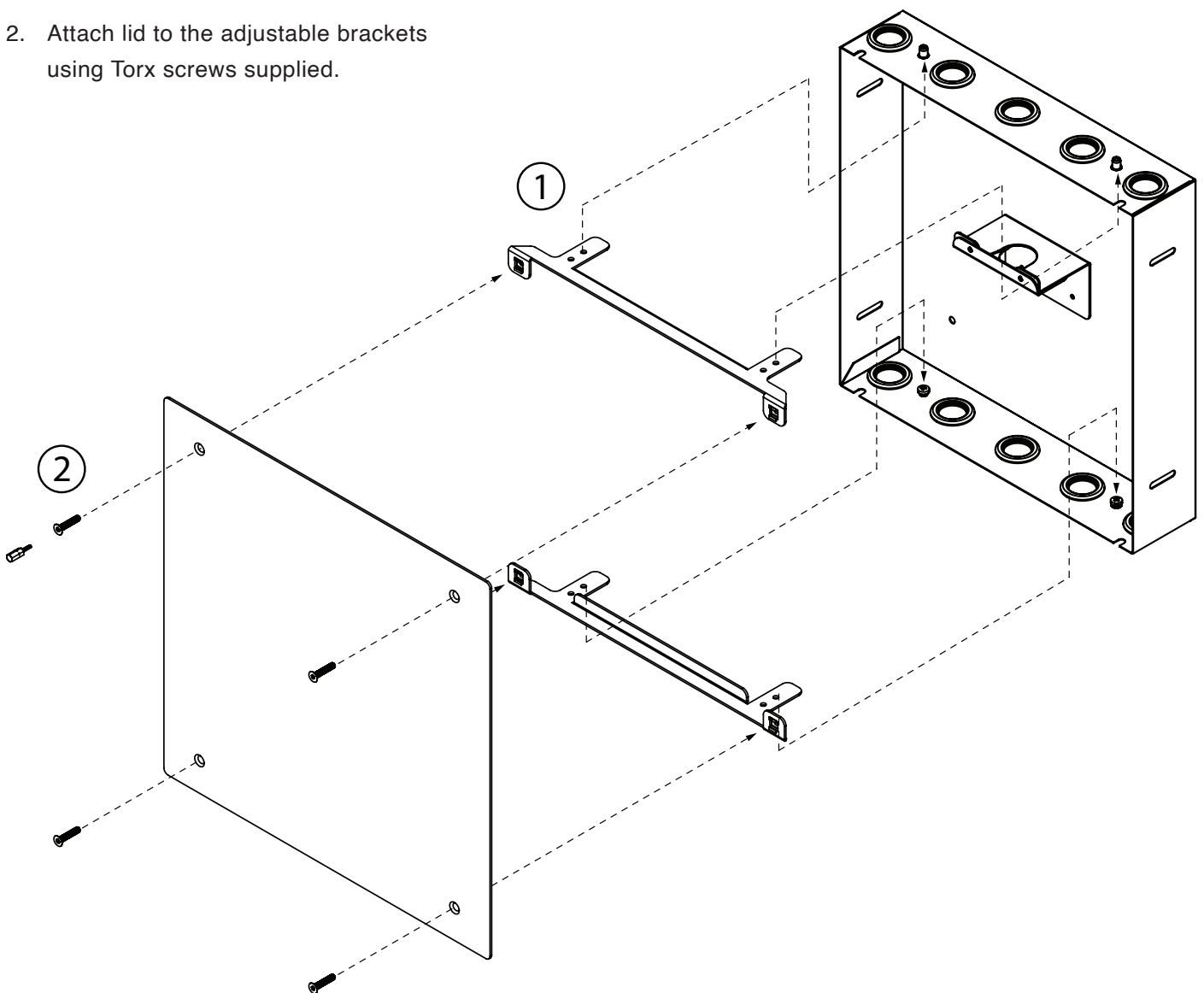

I00508_Version 1.0__15Mar23

TMV Cabinet Security Lid Assembly

DIMENSIONS

ATMSSEC-350

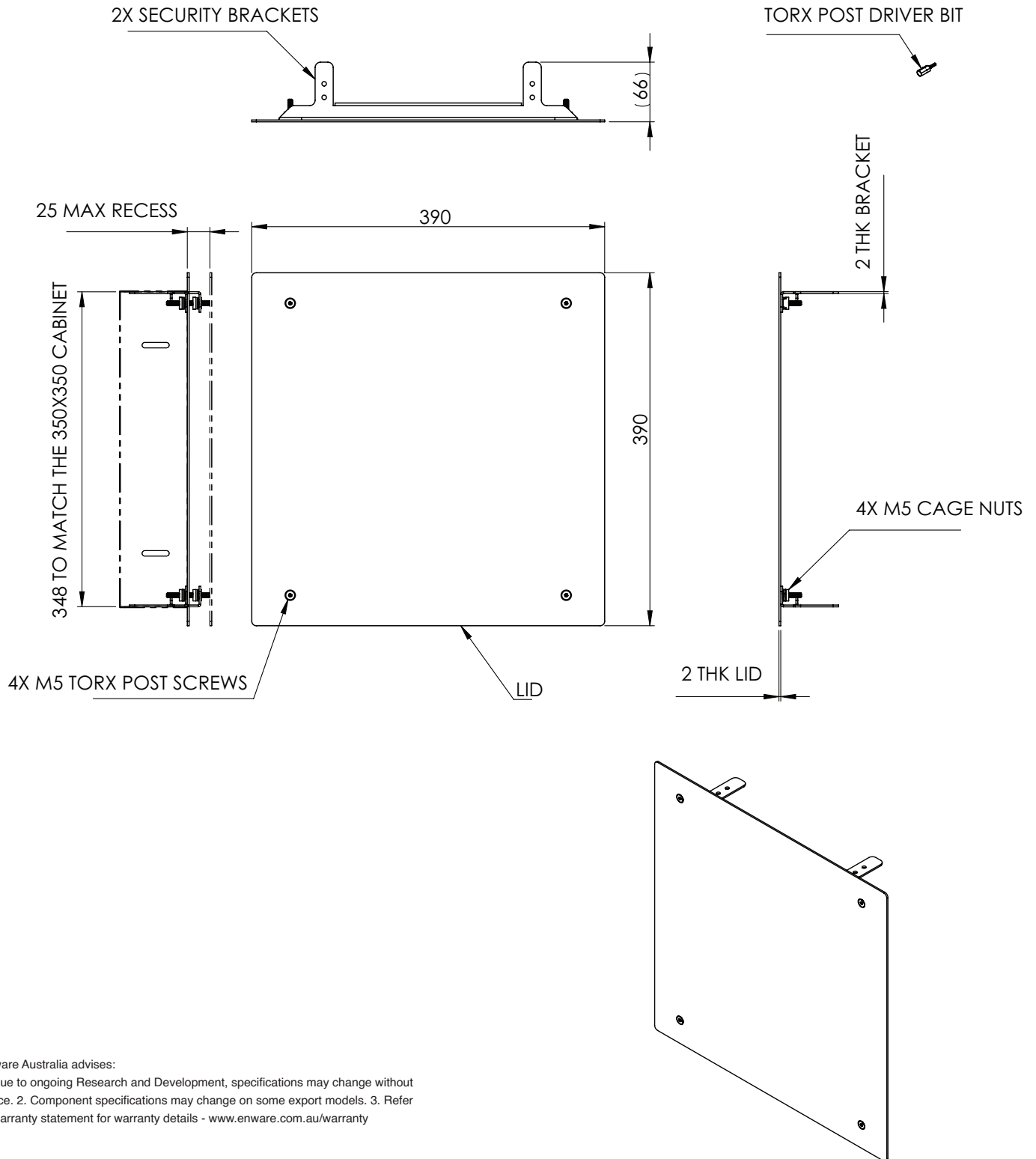

Enware Australia advises:

1. Due to ongoing Research and Development, specifications may change without notice. 2. Component specifications may change on some export models. 3. Refer to warranty statement for warranty details - www.enware.com.au/warranty

I00508_Version 1.0__15Mar23

TMV Cabinet Security Lid Assembly

DIMENSIONS

ATMSSEC-430

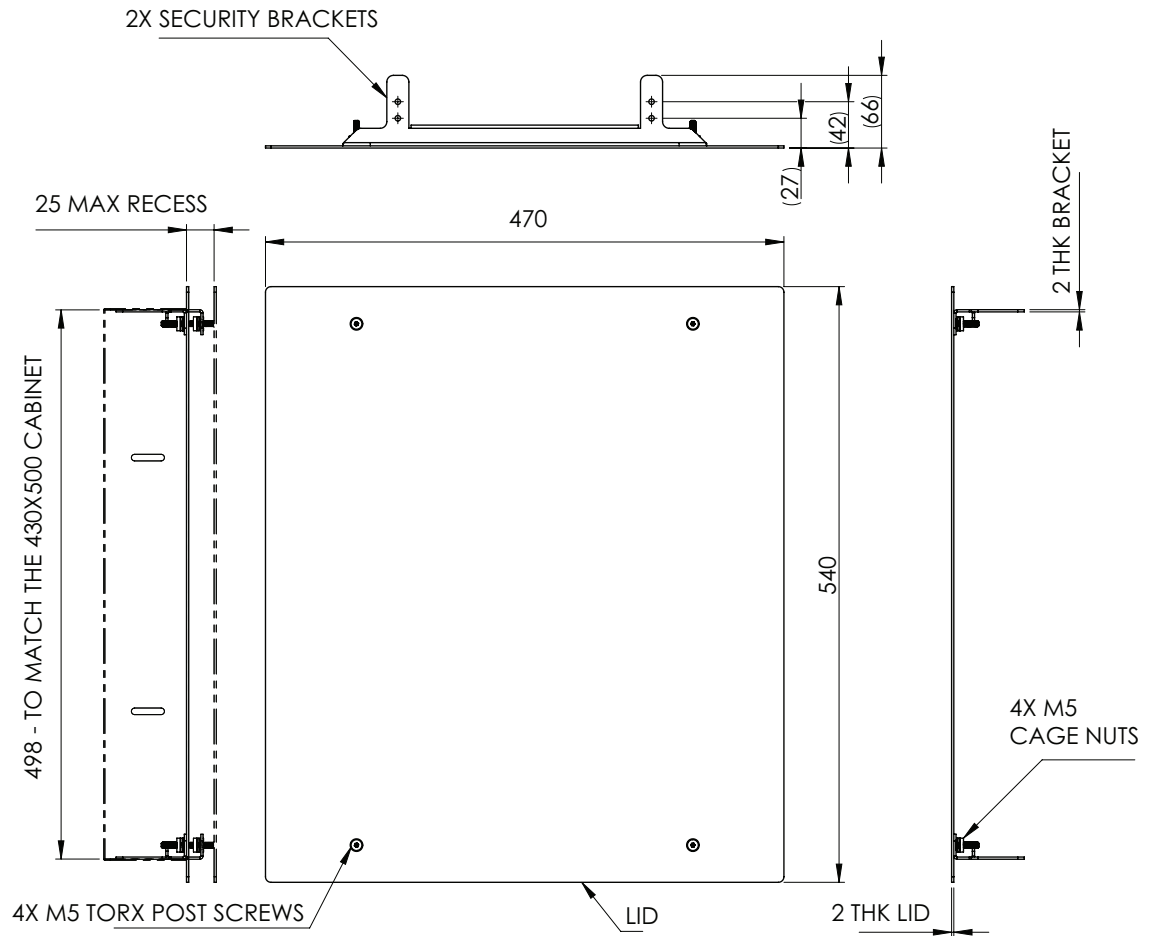

TORX POST DRIVER BIT

Enware Australia advises:

1. Due to ongoing Research and Development, specifications may change without notice. 2. Component specifications may change on some export models. 3. Refer to warranty statement for warranty details - www.enware.com.au/warranty

I00508_Version 1.0__15Mar23