

TYPE 61 HOB MOUNTED BUTTON ACTION BUBBLER

Installation & Maintenance Instructions

BUB290

BUB290B



I00038_FEB23

Call 1300 369 273
www.enware.com.au

Enware Australia
9 Endeavour Rd Caringbah NSW 2229 Australia
Ph: 02 8536 4000 info@enware.com.au



technical data

Technical Information

| | |
|-------------------------------|---|
| Inlet Connection | 3/8"x18 NPSM Female (BUB290) 1/2" BSP Male (BUB290B) |
| Recommended Working Pressure | 100- 500 kPa |
| Flow Rate | 2 l/minute (adjustable) |
| Recommended Temperature Range | 5-30 °C |

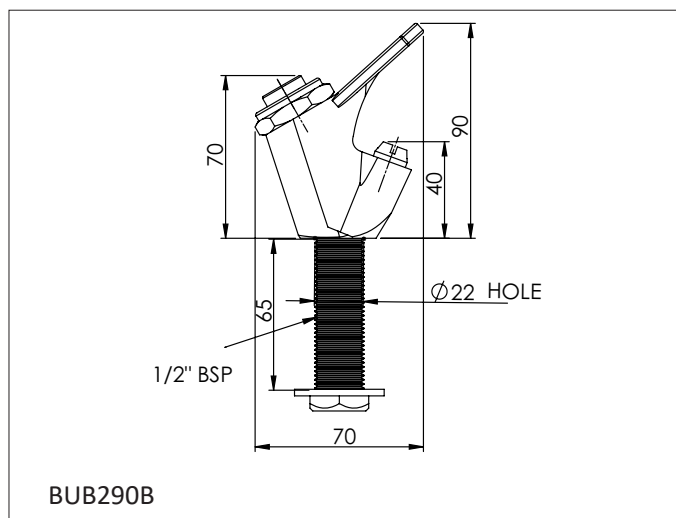
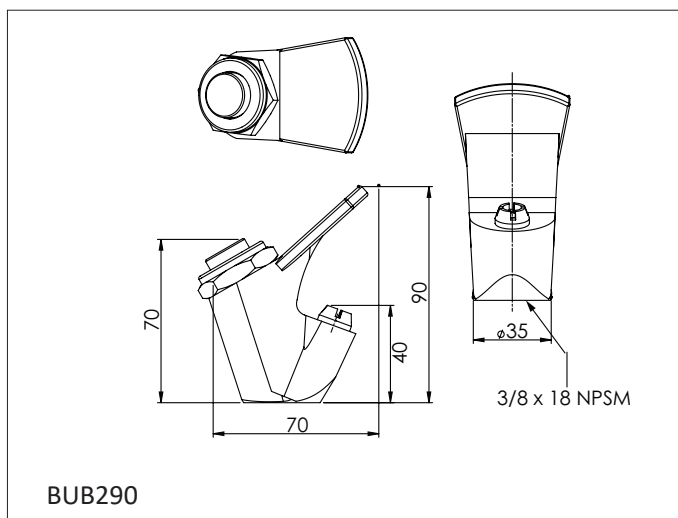

installation compliance

Before proceeding with installation ensure all operating and dimensional specifications are suitable for the intended installation.

Ensure all supply lines are flushed thoroughly to remove debris prior to the installation of this product. Strainers are recommended if debris is an ongoing problem. A pressure reduction valve may be required to comply with recommended maximum supply pressure.

Enware products must be installed in accordance with AS/NZS 3500 – Plumbing and Drainage, the Plumbing Code of Australia as well as imposed Local and State / Territory Legislative requirements and the manufacturer's instructions.

installation instructions

INSTALLATION

1. The bubbler is supplied fully assembled. To install, use a thread sealant tape to seal to the 3/8" BSP male thread connection.
2. Screw the bubbler onto the thread.
3. Turn water on and check for leaks at the inlet connection.
Operate bubbler – flow may need to be adjusted to a higher or lower height.

SETTING WATER STREAM HEIGHT

Operate bubbler to determine if the water stream height is satisfactory. If not:

1. Using a suitable spanner, undo the hex dress nut. Remove the hex dress nut and push button from the bubbler body. The nut and push button can be removed to reveal the top of the spring cartridge and the cartridge locking ring. (Water does not have to be shut off for this step.)
2. Using a small flat sided screwdriver, locate the flow adjustment screw on top of the cartridge. While pushing down on the spindle (the bubbler is in the fully open position and water is at full flow), gently turn the adjustment screw clockwise to reduce stream height, or anticlockwise to increase stream height.
3. Replace push button and hex dress nut, and tighten the hex dress nut.
4. Turn water on and test for correct operation.

service & maintenance

Refer to Troubleshooting chart below for specific problems and solutions.

The cartridge (BUB294) is not serviceable so unless the problem is external to the cartridge and easily identified (i.e. debris blocking the inlet), a complete cartridge will be required.

REPLACING BUBBLER CARTRIDGE

1. Shut off water supply.
2. Using a suitable spanner, undo the hex dress nut. Remove the hex dress nut and push button.
3. Using suitable circlip pliers or Type 61 spanner, unscrew and remove the cartridge retaining nut, then pull the cartridge out. Ensure that the bottom sealing washer is also removed with the cartridge, and not left behind on the bubbler seat. Set retaining components aside being careful not to lose the smaller parts.
4. Install a new cartridge ensuring that the bottom sealing washer is in place and that the cartridge locates correctly into the spigot holes.
5. Fit the cartridge retaining nut back on and tighten. Do not overtighten.
6. Replace push button and hex dress nut, and tighten the hex dress nut.
7. Turn water on and test for correct operation.

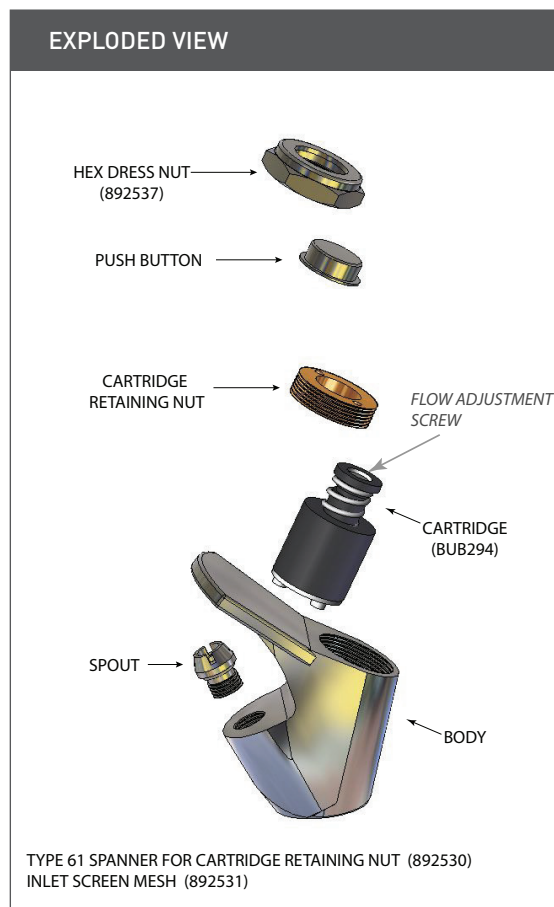

troubleshooting

| PROBLEM | CAUSE | RECTIFICATION |
|---|---|--|
| Water runs constantly from bubbler outlet | Debris in cartridge | Replace cartridge BUB294 |
| | Cartridge has been damaged | Replace cartridge BUB294 |
| | Seating washer damaged or spring broken | Install a pressure reduction valve. Replace cartridge BUB294 |
| No flow from bubbler outlet | Water supply turned off | Turn water on |
| | Debris fouling inlet or outlet ports of cartridge | Remove blockage |
| | Rubbish/debris fouling outlet | Remove blockage |
| Water discharge from top of bubbler | Cartridge is damaged | Replace cartridge BUB294 |



ADDRESS: 9 Endeavour Rd Caringbah NSW 2229 Australia

POSTAL ADDRESS: P.O. Box 2545, Taren Point NSW 2229 Australia

PHONE: +61 2 8556 4000

1300 369 273 (AUS) WWW.ENWARE.COM.AU INFO@ENWARE.COM.AU