

# Concealed Spindle Bib Tap FI 50mm Extended - Aerated Outlet - Jumper Valve

Concealed spindle tapware series is robust and vandal resistant. The ergonomically designed handle features a dress skirt which conceals the anti-vandal handle fixing and spindle, for aesthetics and easier cleaning. Ideal for commercial, institutional and public amenity applications.

## KEY FEATURES

- Jumper Valve
- Fixed spout bib tap
- Vandal-resistant internal locking ring secures the handle which requires special key to release (key supplied)
- Blue (Cold), Red (Hot) or Yellow (Warm) coloured indicator button. (3 colour indicator buttons included)
- Serviceable with all wearing components replaceable, thus providing an even longer life
- Constructed from dezincification resistant (DR) brass
- Durable bright chrome finish

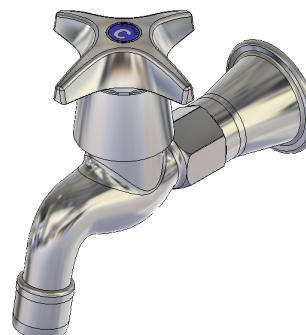

## PRODUCT CODE

CS322F

Concealed Spindle Bib Tap FI 50mm  
Extended - Aerated Outlet - Jumper Valve



Products are to be installed in accordance with the Plumbing Code of Australia and AS/NZS3500. Reference should also be made to the Australasian Health Facility Guidelines (AHFG), ABCB and Local Government regulations when considering the choice of, and the installation of these products.

This product is compliant with the Lead Free requirements of NCC Volume Three.

Due to ongoing Research and Development, specifications may change without notice. Component specifications may change on some export models.

Refer to warranty statement for warranty details - [www.enware.com.au/warranty](http://www.enware.com.au/warranty).

## TECHNICAL DATA

Inlet Connection	1/2" BSP (15mm) FI
Recommended Pressure	50kPa – 500kPa
Maximum Static Pressure	1200kPa
Maximum Recommended Temperature	50°C
Maximum Jumper Valve Working Temperature	95°C
Flow Rate	8L/min
Finish	Chrome
Valve Type	Jumper Valve

