

Plug and Play Alarm System with Combination Audio-Visual and BMS Capability

INSTALLATION INFORMATION

PLUG & PLAY INSTALLATION

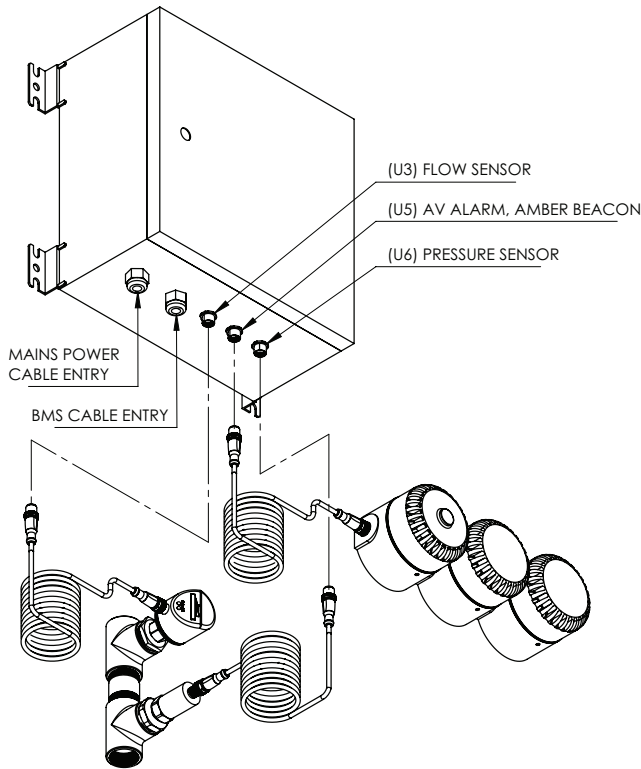

INTERNAL ELECTRICAL CONNECTION

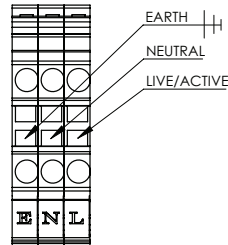

- MAIN POWER INPUT
- NOMINAL VOLTAGE: 230VAC.
 - NOMINAL FREQUENCY: 50Hz
 - NOMINAL CURRENT: 1A
 - CABLE DIAMETER: 5 - 10mm
 - WIRE SIZE: 0.14 - 1.5mm²

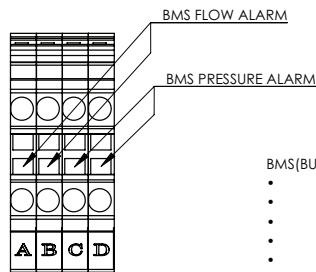

- BMS (BUILDING MANAGEMENT SIGNAL):
- INTERFACE TYPE: SWITCH (DRY CONTACT)
 - OUTPUT TYPE: OPEN/CLOSE (ALARM=RELAY CLOSED)
 - MAX. VOLTAGE: 125VDC, 380VAC.
 - MAX. CURRENT: 3A
 - CABLE DIAMETER: 5-10mm
 - WIRE SIZE: 0.14-1.5mm²

NOTES:-

1. ALL HARD WIRED CONNECTIONS TO BE MADE BY A LICENCED ELECTRICIAN.
2. CONNECTION TO APPROPRIATE TERMINALS TO BE COMPLETED AS PER AS/NZS 3000:2018.

24V NON HAZARDOUS AUDIO VISUAL BMS, FLOW AND PRESSURE SENSOR

EAA953PP | EAA953PP-E | EAA953PP-P

SIGNAL

SENSORS

When the shower and/or eyewash is activated by sensing the flow of water or a pressure drop, a signal will be automatically sent to the junction box.

PRESSURE SENSOR

FLOW SENSOR

JUNCTION BOX

A trigger from the sensors will send a signal to the sounder and beacons and BMS.

SOUNDER & BEACONS

SOUNDER

Sounder activated by flow or pressure sensors

RED BEACON

Red Beacon activated by flow sensor

AMBER BEACON

Amber Beacon activated by pressure sensor

BMS

Signal sent to BMS by flow or pressure sensors

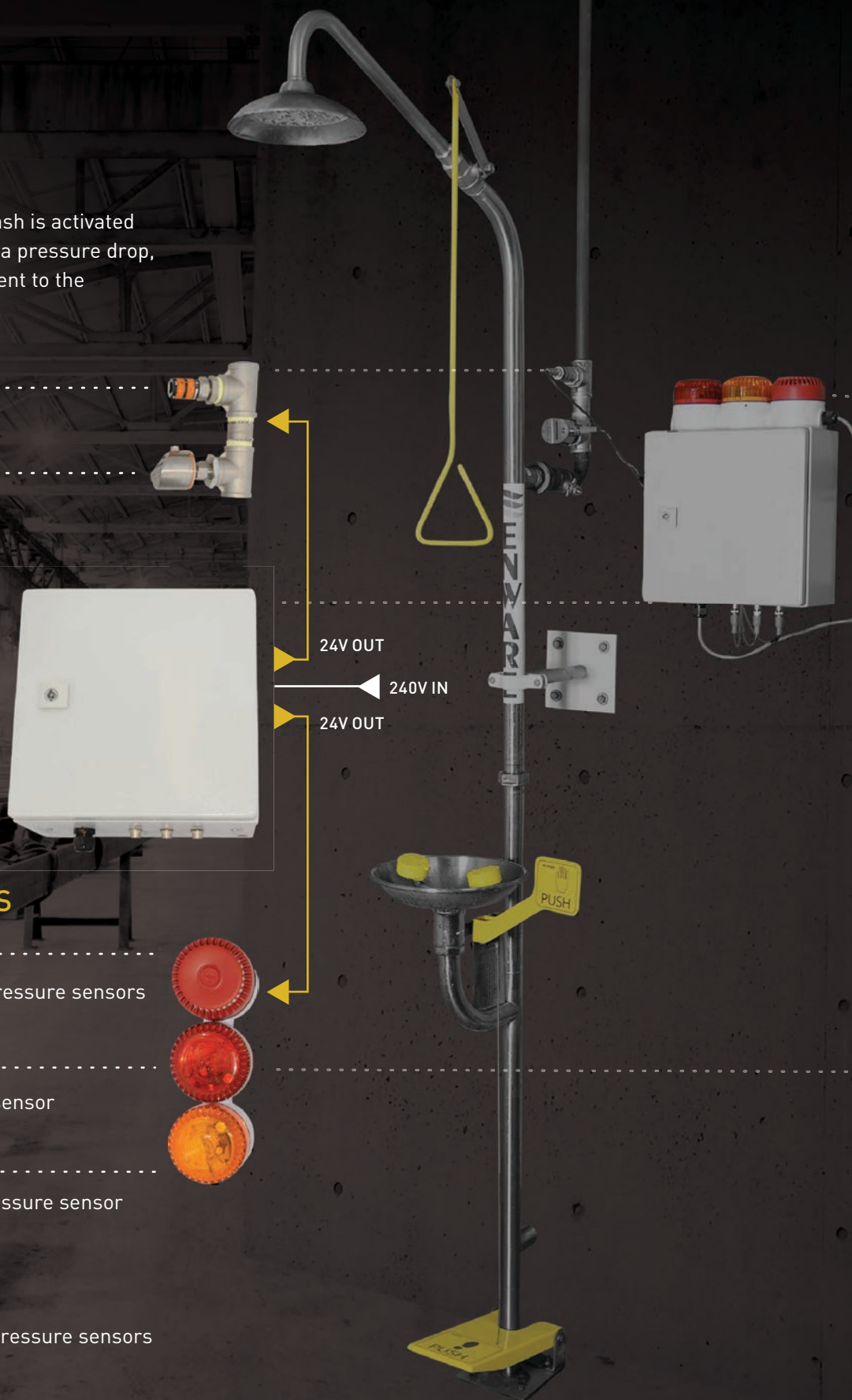

Call 1300 369 273

www.enware.com.au

Enware Australia Pty Limited

9 Endeavour Rd Caringbah NSW 2229 Australia

 ENWARE

Version: June 19