

Earth Lug Plus Bracket to suit ECE Showers and Pedestal Eyewashes

The Earthing Lug is an essential component for safe and effective electrical grounding across various installations. This durable, corrosion-resistant lug features a 50mm × 100mm tag bent at 150°, with two drilled holes and an integrated clamp for easy installation and reliable electrical conductivity. Designed specifically for ECE shower and pedestal eyewash units where earthing is required.

KEY FEATURES

- Strong and durable corrosion-resistant construction - SS316 lug and SS304 bracket
- 50mm × 100mm lug, bent at 150°
- Two drilled mounting holes for secure attachment
- Includes bracket to suit ECE showers and pedestal eyewashes
- Easy to install - mounts directly to the main upright frame near ground level
- Flexible design – fits during installation or can be retrofitted post-install
- No welding required

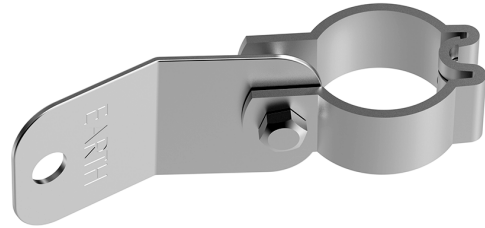

PRODUCT CODE

EAA975

Earth Lug Plus Bracket to suit ECE Showers and Pedestal Eyewashes

Earth Lug Plus Bracket to suit ECE Showers and Pedestal Eyewashes

TECHNICAL DATA

Finish	Stainless Steel
--------	-----------------

COMPATIBLE PRODUCTS

ECE060	Emergency Stainless Steel Combination Shower with Hand Operated Eye Wash
ECE090	Emergency Stainless Steel Combination Shower Hand/Foot Operated Eye Wash
ECE240	Emergency Stainless Steel Combination Shower with Hand Operated Eye/Face Wash
ECE270	Emergency Stainless Steel Combination Shower with Hand/Foot Operated Eye/Face Wash

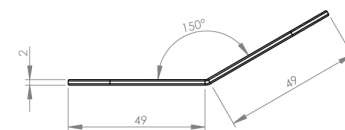
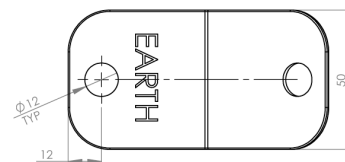
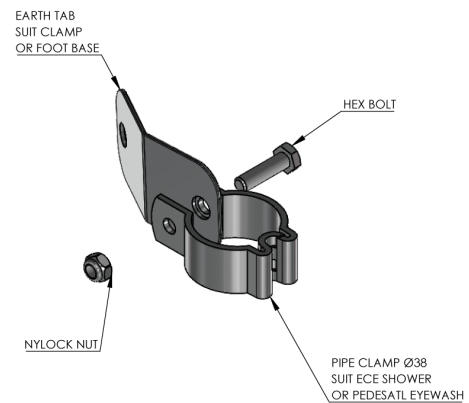
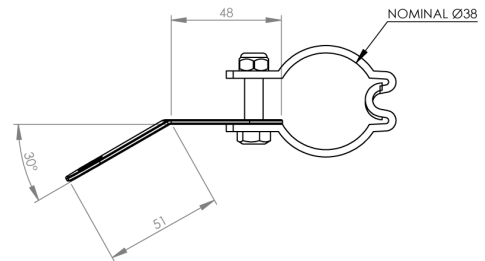

Due to ongoing Research and Development, specifications may change without notice.
 Component specifications may change on some export models.
 Refer to warranty statement for warranty details - www.enware.com.au/warranty.