

24V Hazardous Alarm System: Audio Visual Alarm and BMS Capability

In an emergency situation, every second counts, a quick response is paramount when it comes to minimising the impact of a workplace injury.

Those precious first few seconds really do count, and installing an alarm system is a great way of making sure workmates and first aid personnel are immediately aware that an employee is injured and requires urgent assistance.

The EAH53 system includes an audio visual alarm with BMS capability designed for Zone 1 rated site environments.

KEY FEATURES

- 24V system
- Audio Visual Alarm and BMS capability
- Alarm system can be retrofitted to existing shower and eye wash system
- Electronic inline flow sensor triggers the alarm - transmits a signal to the BMS
- Electronic inline pressure sensor triggers the alarm - transmits a signal to the BMS
- Zone 1 rated flow sensor, pressure sensor, sounder and beacon
- Junction box to be mounted in safe zone



PRODUCT CODES

EAH53	Combination Shower
EAH53-E	Eye/Eye Face Wash
EAH53-P	Platform Shower

Due to ongoing Research and Development, specifications may change without notice.
Component specifications may change on some export models.
Refer to warranty statement for warranty details - www.enware.com.au/warranty.

24V Hazardous Alarm System: Audio Visual Alarm and BMS Capability

TECHNICAL DATA

Input Voltage	240V
Output Voltage	24V
IP Rating of Alarm System	IP65
Flow Sensor	Electronic; able to pre-set flow rate required (by customer)
Pressure Sensor	Electronic; able to pre-set pressure drop point (by customer)
Sounder Decibel Rating	100 db(A) @ 1m
Beacon Lens Colours	Red (Flow Sensor)
Material (Junction Box)	GRP (Fibreglass)

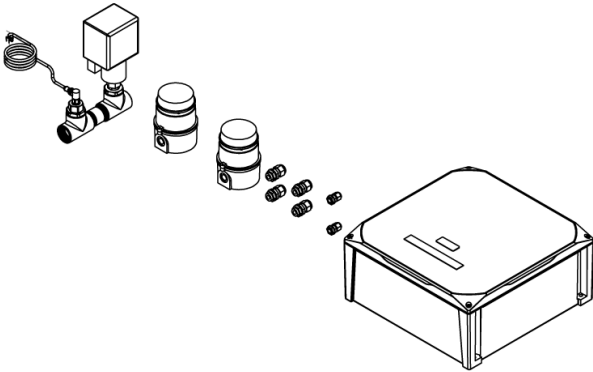
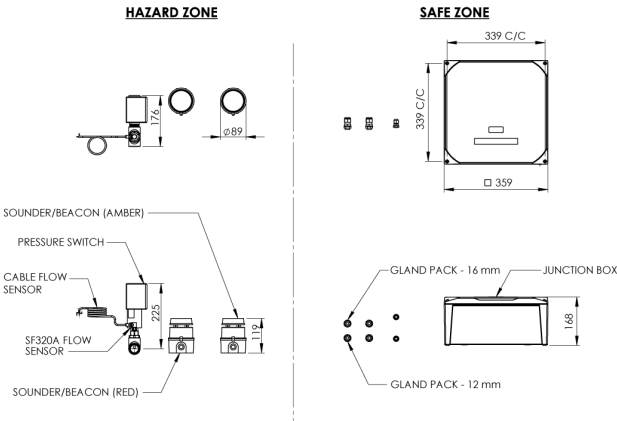

DESCRIPTION	CERTIFICATE NUMBER
SOUNDER/BEACON (RED) - IS-mC1-R/R	IECEX SIR 06.0045X
SOUNDER/BEACON (AMBER) - IS-mC1-R/A	IECEX SIR 06.0045X
FLOW SENSOR - SF320A HAZ ZONE 2G	IECEX BVS 06.0007
FLWSWITCH CONNECTION CABLE BLUE	IECEX BVS 11.0002X
PRESSURE SWITCH NEODYN 100P HAZ	IECEX SIR 10.0009X

WIRING DIAGRAM

