

Wall Mounted Sensor Tap: Hands-Free - 250mm Spout

The Touch-Free Wall Mounted Sensor is a wall-mounted, sensor operated, hands-free tap that is installed above sinks and basins. It operates by sensing a hand in front of the sensor unit. It uses a beam of invisible Infrared light which, when reflected from hand back to the sensor, operates the unit.

KEY FEATURES

- To turn tap on, place hand under spout in front of sensor
- To turn tap off, move hand away
- Valve stays open for 6 seconds, or as long as the hand is within sensor range
- Maximum flow time of 45 seconds per activation reduces waste and prevents vandalism
- Equipped with automatic hygiene flush function (1-10min /24hr) - enabled on request
- Stainless steel sensor plate
- Fixed 250mm spout with 6 Star (4.5 L/min) laminar flow concealed aerator

* Longer flow times, hygiene flush function and other program settings are available at the time of ordering. Contact Enware for more information.



PRODUCT CODE

ENM5071A-250

Wall Mounted Sensor Tap: Hands-Free -
250mm Spout



Products are to be installed in accordance with the Plumbing Code of Australia and AS/NZS3500. Reference should also be made to the Australasian Health Facility Guidelines (AHFG), ABCB and Local Government regulations when considering the choice of, and the installation of these products.

This product is compliant with the Lead Free requirements of NCC Volume Three.

Due to ongoing Research and Development, specifications may change without notice. Component specifications may change on some export models.

Refer to warranty statement for warranty details - www.enware.com.au/warranty.

Wall Mounted Sensor Tap: Hands-Free - 250mm Spout

TECHNICAL DATA

Standard WELS	6Stars
Standard WELS Flow Rate	5.5L/min
Maximum Water Temperature	70°C
Minimum Recommended Pressure	100kPa
Maximum Recommended Pressure	500kPa
Inlet Connection	15mm (1/2" BSP)
Flow Time	Runs as long as hand is within range (Active Sense). When out of range, runs for 6 seconds (Afterflow). Maximum continuous flow period per sensor activation is 45 seconds (Security Time Out).*
Sensor Range	100-235mm
Operating Voltage	24VDC
Maximum Current	1A
Power Consumption - Maximum Load	10W
Sensor Min / Max Ambient Temperature:	Minimum: -5 °C, Maximum: 50 °C
Sensor Protection Rating:	IP67 for the front panel and sensor lens. No IP rating behind panel.

* Timing can be adjusted by use of a remote control- this is best achieved in the Enware factory, but can be performed on site- service call is required and may incur costs. There are limits to adjustability- not all requests can be accommodated.

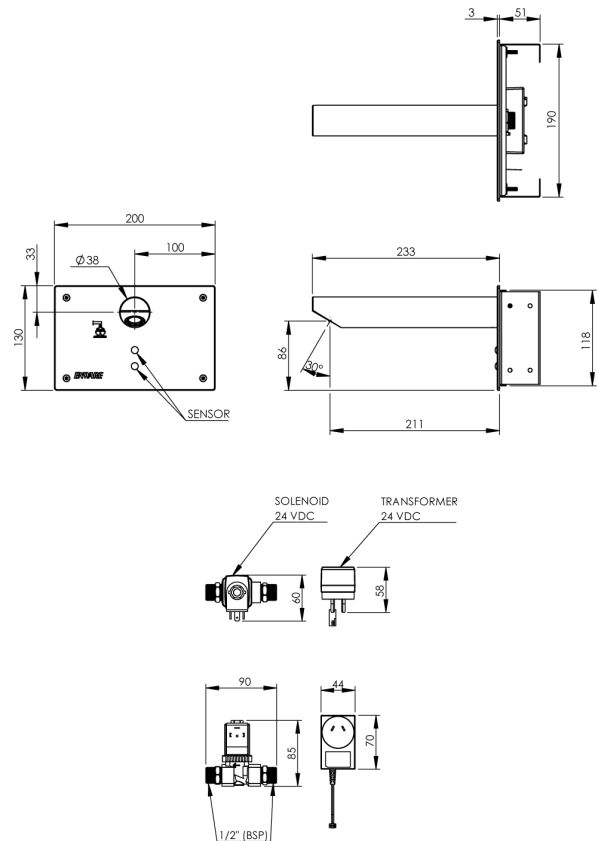

Water Flow Projection

Water Pressure: 350kPa
Flow Rate: 5 L/min

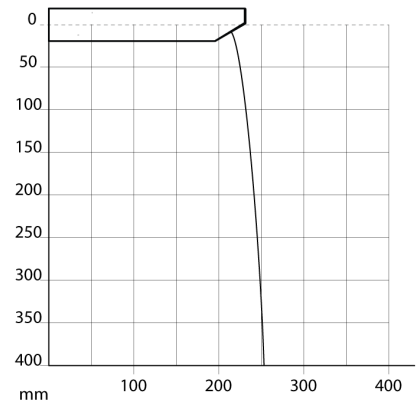

OPTIONAL ACCESSORIES

EMDS801	Spare Parts: EMD Touch-Activated Control Kits - 2m Extension Lead
---------	---

Wall Mounted Sensor Tap: Hands-Free - 250mm Spout

SPARE PARTS

ENMS134A	Spare Parts: Active Sense Stainless Sensor Plate, Bracket, Transformer and Cables
EMDS802	Spare Parts: EMD Touch-Activated Control Kits - Transformer Piezo 24VDC 1.25A 4.6m Lead
WMS8200S	1/2" Solenoid Valve DC S/S
WMS8302	Spare Parts: 1/2"Dc Solenoid Seal Kit Suits Shr/Bsn
EMDS801-4.5	Spare Parts: EMD/ENM50/EMW 4.5m Extension Lead for AC/DC Powerpack
SPC250-SP	Cache Wall Mounted Fixed Spout for Wall Sensor - 250mm

