

# Food Service: Hob Mounted Pre-Rinse Unit with Concealed Mixer Assembly

The Enware Ultra Rinse range of Food Service Pre-Rinse assemblies are designed for use in Commercial Kitchens and Food Preparation areas.

A wide range of products to suit Wall and Bench mounting are available with mixers, pot fillers and various formats to suit different plumbing set-outs.

Heavy duty fixings and chrome plated finishes with anti-vandal fittings ensure easy cleaning for improved hygiene, and long lasting service for critical areas in the kitchen.

Adjustable sets for easy retro-fit and special shortened assemblies ensure there is a solution for all new and existing kitchens.

Service parts such as hoses, trigger sprays, spindles and handles are available to ensure downtime does not interrupt the work flow of a busy kitchen.



## PRODUCT CODE

FHS021

Food Service: Hob Mounted Pre-Rinse Unit  
with Concealed Mixer Assembly

## KEY FEATURES

- Separate bench mounted hot and cold taps to provide either hot, cold water or mixed water
- Dual check valves for backflow protection
- Spring return allows the spray and hose to be pulled into the spraying position and to retract back from the washing area when released
- Pex hose with smooth outer covering and braided inner has in-built swivels to ensure ease of use and to assist to prevent user fatigue
- Quarter-turn, contra-rotating easy to clean 80mm lever handles
- Heavy duty Jumper Valve 1/4 Turn spindles, can be serviced
- Clear identification on all lever handles with blue, yellow, red or grey coloured indicator collars
- Attractive, lead free brass chrome body
- Modular design allows tailoring for individual needs
- FS062 pot filler assembly can be added



Products are to be installed in accordance with the Plumbing Code of Australia and AS/NZS3500. Reference should also be made to the Australasian Health Facility Guidelines (AHFG), ABCB and Local Government regulations when considering the choice of, and the installation of these products.

This product is compliant with the Lead Free requirements of NCC Volume Three.

Due to ongoing Research and Development, specifications may change without notice. Component specifications may change on some export models.

Refer to warranty statement for warranty details - [www.enware.com.au/warranty](http://www.enware.com.au/warranty).

# Food Service: Hob Mounted Pre-Rinse Unit with Concealed Mixer Assembly

## TECHNICAL DATA

Standard WELS	6Stars
Standard WELS Flow Rate	4L/min
Valve Type	1/4 Turn Jumper Valve
Maximum Working Temperature	70°C
Minimum Recommended Pressure	100kPa
Maximum Recommended Pressure	500kPa
Maximum Static Pressure	800kPa
Inlet Connection	1/2" BSP (15mm)

Ensure spring return and hose movement is not impeded by surrounding equipment, benches and shelving.

Applying excessive pulling force may damage the hose assembly.

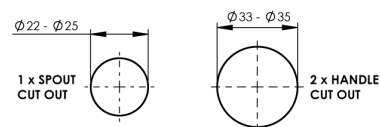
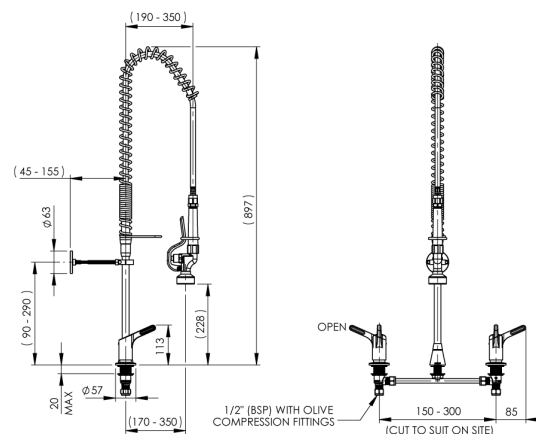

INSTALLATION DETAIL  
(BENCHTOP CUT OUT)  
CUT HOLES TO SUIT HANDLES  
AND OUTLET POSITIONS

## OPTIONAL ACCESSORIES

FS729SS-KIT	FS729SS-KIT- Soft Spray conversion kit for FS729 trigger spray
FS062	Food Service: Riser Pot Filler with 230mm Spout

# Food Service: Hob Mounted Pre-Rinse Unit with Concealed Mixer Assembly

## SPARE PARTS

FS070	Spare Parts: Adjustable Wall Bracket - Standard
FS072	Spare Parts: Trigger Spray Hook
FS077NS	Spare Parts: Service Kit Suits FS729
FS721S	Spare Parts: Food Service - Stuffing Box Assembly - FS721/FS729
FS790	Spare Parts: Trigger Spray Handle & Screw Replacement Part
FS729	Spare Parts: Food Service - Pre-Rinse Ultra Rinse Trigger Spray
FSHOSE100	Spare Parts: Hose 15mm 1/2"BSP FI X M15 - 1000mm Post March 24
FSHOSE100KIT	Spare Parts: Hose Kit 15mm 1/2 BSP FI x M15 1000mm with Spring Suits Pre April 24
FS795	Spare Parts: Food Service - Ultra Rinse Face Trigger Spray
FS734	Spare Parts: Washer Service Kit - O-Rings, Grub Screws, Aerator
FSJ095LTC	Spare Parts: Food Service Lever Handle 80mm Top Assembly - Jumper Valve - 1/4 Turn SBA LTC - Pillar/Bib - Colour Indicators
FSJ096RTC	Spare Parts: Food Service Lever Handle 80mm Top Assembly - Jumper Valve - 1/4 Turn Rising SBA RTC - Pillar/Bib - Colour Indicators
JHS380LTC	Spare Parts: Lever Action - Pillar/Bib Stuffing Box Assembly - 1/4 Turn Jumper Valve - LTC
FS053L	Riser Assembly 300mm Low Lead
FS013	Spare Parts: Hob Mounted - Concealed Mixer Base - Concealed
WLJS398	Spare Parts: Wellbeing Leva Colour Indicator Kit Jv
FSJ378-80	Spare Parts: Food Service - Lever Handle 80mm - Jumper Valve - Colour Indicators
FS066	Spare Parts: Spring Retainer Extension LL