

Wall Mounted Concealed Mixer Base

Wall Mounted Concealed Mixer Base

KEY FEATURES

- Base wall mixing set- requires in wall recess tee
- Jumper Valve 1/4 Turn handles
- Wall Base for spout or pre-rinse assembly.
- Consider exposed wall set as better option where recess may require extended spindles



PRODUCT CODE

FS023

Wall Mounted Concealed Mixer Base



Products are to be installed in accordance with the Plumbing Code of Australia and AS/NZS3500. Reference should also be made to the Australasian Health Facility Guidelines (AHFG), ABCB and Local Government regulations when considering the choice of, and the installation of these products.

This product is compliant with the Lead Free requirements of NCC Volume Three.

Due to ongoing Research and Development, specifications may change without notice. Component specifications may change on some export models.

Refer to warranty statement for warranty details - www.enware.com.au/warranty.

TECHNICAL DATA

Valve Type	1/4 Turn Jumper Valve
Maximum Working Temperature	70°C
Minimum Recommended Pressure	50kPa
Maximum Recommended Pressure	500kPa
Maximum Static Pressure	800kPa
Finish	Chrome

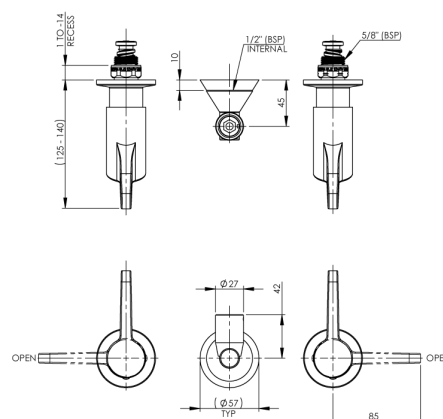

Wall Mounted Concealed Mixer Base

SPARE PARTS

JHS382LTC	Spare Parts: Lever Action - Rising Spindle Recess Stuffing Box Assembly - 1/4 Turn Jumper Valve - LTC
JHS382RTC	Spare Parts: Lever Action - Rising Spindle Recess Stuffing Box Assembly - 1/4 Turn Jumper Valve - RTC
FSJ308LTC	Spare Parts: Food Service Lever Handle 80mm Recess Adaptor - Jumper Valve - 1/4 Turn Rising SBA LTC - Colour Indicators
FSJ308RTC	Spare Parts: Food Service Lever Handle 80mm Recess Adaptor - Jumper Valve - 1/4 Turn Rising SBA RTC - Colour Indicators
FSJ378-80	Spare Parts: Food Service - Lever Handle 80mm - Jumper Valve - Colour Indicators
WLJS398	Colour Indicator Kit JV
FS020	Wall Mounted - Riser Base
MIS592	Allen Key (3/32) Spouts Etc