

# Slimline Fume Cupboard Outlet

## Installation and Maintenance Instructions

LCN160DRY      LCN166DRY  
LCN160GAS      LCN166GAS  
LCN160OXY      LCN166OXY  
LCN160VAC      LCN166VAC  
LCN160WATER    LCN166WATER  
LCN161DRY  
LCN161GAS  
LCN161OXY  
LCN161VAC  
LCN161WATER

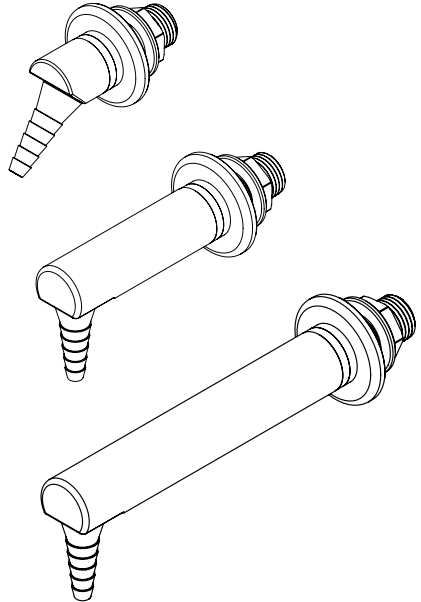

Enware products are to be installed in accordance with the Plumbing Code of Australia (PCA), AS/NZS3500, AS5601, AS2896 and other applicable local, national or state regulatory requirements or standards. Installations not complying with the above may void the product and performance warranty provisions.

Reference should also be made to the Australasian Health Facility Guidelines (AHFG), ABCB and Local Government regulations when considering the choice of, and the installation of these products.

This product must be installed and commissioned by a qualified plumber.

For use with potable water only.

NOTE: Enware Australia advises:

1. Due to ongoing Research and Development, specifications may change without notice.
2. Component specifications may change on some export models.

All measurements are in millimetres.

I00560\_17 Apr 2024

1300 369 273 | [info@enware.com.au](mailto:info@enware.com.au) | [enware.com.au](http://enware.com.au)

**ENWARE**  
A WATTS Brand

---

## technical data

### WATER FITTINGS

<b>Working Pressure Range</b>	Min 20 kPa Max 700 kPa
<b>Maximum Working Temperature</b>	90°C
<b>Inlet Connection</b>	1/2" BSP Male / 1/4" BSP Female
<b>Outlet Connection</b>	Tube Nozzle/ 3/8" BSP Female (without nozzle)
<b>Flow Rate</b>	6 L/min
<b>Water Options</b>	Cold, Hot, Chilled Water

### DRY MEDIA FITTINGS

<b>Maximum Working Pressure</b>	700 kPa (dry media)
<b>Inlet Connection</b>	1/2" BSP Male / 1/4" BSP Female
<b>Outlet Connection</b>	Tube Nozzle/ 3/8" BSP Female (without nozzle)
<b>Dry Media Options</b>	Argon, Carbogen, Carbon Dioxide, Compressed Air, Helium, Nitrogen, Oxygen, Vacuum

### BURNING GAS FITTINGS

<b>Maximum Working Pressure (Needle Valve)</b>	700 kPa (burning gases)
<b>Inlet Connection</b>	1/2" BSP Male / 1/4" BSP Female
<b>Outlet Connection</b>	Tube Nozzle/ 3/8" BSP Female (without nozzle)
<b>Burning Gas Options</b>	Natural Gas, LPG

---

## before installation

- All supply lines must be flushed thoroughly to remove debris prior to the installation of this product, as per AS/NZS 3500.1. Strainers (40 mesh) are recommended if debris is an ongoing problem.
- A pressure reduction valve may be required to comply with the recommended maximum supply pressure and/or balanced pressure requirements.

# installation

1. Prepare 1 tap hole on mounting surface.  
Drill hole size: 22mm, with anti-rotation pin 5mm hole at 16mm from centre. **SEE IMAGE 01**  
  
Fit the base flange onto the tail temporarily, and check the position of anti-rotation pin, as the orientation may vary.
2. Before drilling the holes, check that the maximum thickness of the mounting surface is suitable for the outlet.  
Note: Maximum thickness 8mm (with 1/2" inlet connection) or 20mm (with 1/4" inlet connection)
3. Fit colour indicator rings onto spout. **SEE IMAGE 02**  
(See Colour Coded Identification Chart next page.)
4. Screw base flange onto the tail.  
Fit O-ring on base flange.
5. Fit the outlet through the tap hole.  
Screw back nut from behind the wall and tighten with a spanner to secure the outlet in place. **SEE IMAGE 03**
6. Connect water / gas supply to the inlet thread connection. (1/2" BSP male or 1/4" BSP female)
7. Turn on water / gas supply, test for correct operation and check for leaks.

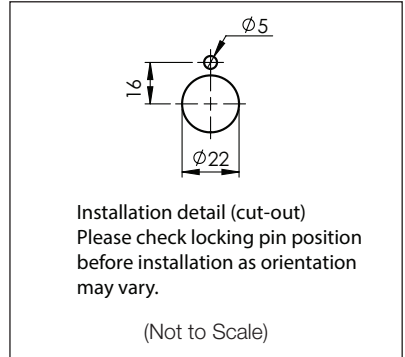

IMAGE 01

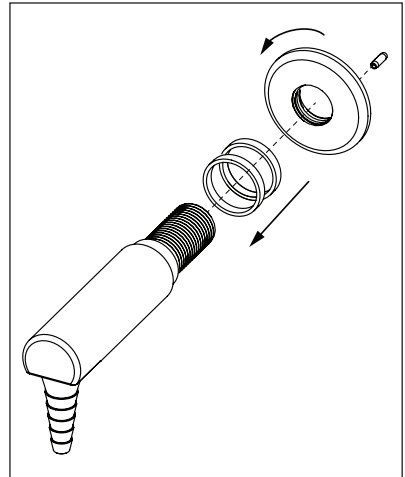

IMAGE 02

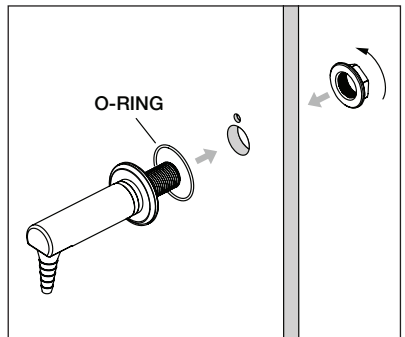
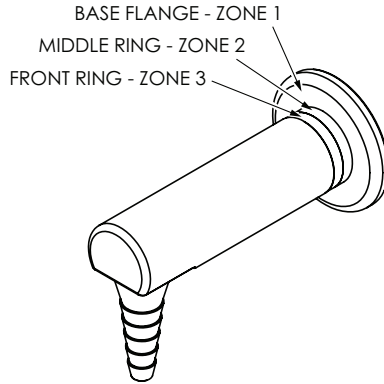

IMAGE 03

## COLOUR CODED IDENTIFICATION CHART

Colour coding for media identification follow the recommendations of DIN EN 13792.



MEDIA	ZONE 1	ZONE 2	ZONE 3
<b>WATER</b>			
COLD WATER	GREEN	GREEN	BLUE
HOT WATER	GREEN	GREEN	RED
CHILLED WATER	GREEN	BLUE	BLUE
<b>GAS</b>			
ARGON	BLUE	GREY	GREY
CARBOGEN	BLUE	BLACK	BLUE
CARBON DIOXIDE	BLUE	BLUE	BLACK
COMPRESSED AIR	BLUE	BLUE	YELLOW
HELIUM	BLUE	GREY	WHITE
NITROGEN	BLUE	GREEN	GREEN
OXYGEN	BLUE	BLUE	BLUE
VACUUM	GREY	GREY	GREY
<b>BURNING GASES</b>			
NATURAL GAS	YELLOW	YELLOW	YELLOW
LPG	YELLOW	RED	YELLOW

---

# maintenance

## CLEANING

Enware products should be cleaned with a soft damp cloth using only mild liquid detergent or soap and water. Do not use cleaning agents containing a corrosive acid, scouring agent or solvent chemicals. Do not use cream cleaners, as they are abrasive. Use of unsuitable cleaning agents may damage the surface. Any damage caused in this way will not be covered by warranty.

## TUBE NOZZLE (WATER FITTINGS)

In the event of blockage, tube nozzle on the spout should be checked and cleaned for debris.

Unscrew tube nozzle, inspect and reverse rinse internal components under running water to clear any debris. Replace components if necessary.

**SEE IMAGE 04**

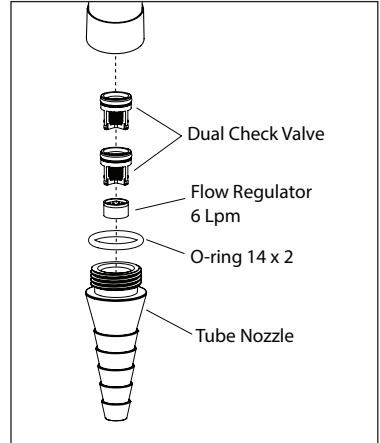
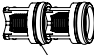



**IMAGE 04**

## troubleshooting

PROBLEM	CAUSE	RECTIFICATION
Water is not flowing from tap	Flow control is blocked by debris.	Remove flow control and clean debris.
Poor water flow from outlet		Install an inline strainer.

## spare parts

	Description	Part Code
	Tube nozzle (for gas / dry media)	<b>LCN170</b>
	Tube nozzle with check valve (for water)	<b>LCN171</b>
	2x Check valve to suit tube nozzle LCN (for water)	<b>LCN187</b>
	Flow control 6 Lpm for tube nozzle LCN (for water)	<b>LCN190</b>

# product warranty statement - WATTS AUSTRALIA

EFFECTIVE FROM 20 November 2023

This Warranty Statement applies to products supplied by Australian Valve Group Pty Ltd (ACN 068 227 270) (**AVG**) or Enware Pty Ltd (ACN 662 302 767) (**Enware**) (each of AVG and Enware, a Supplier) and installed within Australia.

Subject to the terms and conditions outlined in this Warranty Statement, each Supplier warrants to its customers that a product supplied by it (**Product**) will be free from all defects in material and workmanship under normal usage for the applicable Warranty Period (as set out in the Warranty Table below). The Warranty Period commences from the date of delivery of the relevant Product.

## 1. Conditions

The warranty provided under this Warranty Statement will not apply in respect of a Product (or any Product defect, fault or resulting damage) if:

- (a) the Product is not installed and maintained in accordance with the requirements of the applicable laws, standards and codes (including, without limitation to, the National Construction Code Volume Three – Plumbing Code of Australia, associated reference standards as applicable at the time and AS/NZS 3500);
- (b) the Product is not installed and maintained by a qualified technician in accordance with the relevant installation and operation manual and instructions; and
- (c) any Product defect, faulty or resulting damage arises from:
  - (i) failure by you or any other person to follow the relevant manual or instructions (relating to the handling, storage, installation, fitting, connection, adjustment, maintenance or repair of the Product) published or provided by the Supplier;
  - (ii) failure by you or any other person responsible for the fitting, installation, or other work on the Product to follow or conform to applicable laws, standards and codes (including, without limitation to, the AS/NZ 3500 set of Standards, all applicable State and Territory Plumbing Codes, the Plumbing Code of Australia and directions and requirements of local and other statutory authorities);
  - (iii) any parts or components not manufactured by the Supplier (or otherwise not authorised by the Supplier) are installed or combined with the Product, without the prior authorisation of the Supplier; or
  - (iv) any act or circumstance beyond our control including, without limitation to, accident, abnormal use, vandalism, fouling caused by foreign material, damage from adverse water conditions, chemical, acts of God, damage to buildings, other structures and infrastructure and loss or damage during transit or transportation of the Product, or any abuse, misuse, misapplication, improper installation or connection, or improper maintenance or alteration of the Product.

## 2. Make a claim

To make a claim under this Warranty Statement, you must notify the relevant Supplier in writing within 7 days of any alleged defect in the Product coming to your attention and provide the Supplier with proof of your purchase of the Product to the relevant Supplier:

- (a) If the Product is supplied by **AVG**, please contact AVG by telephone at 1800 284 287, or by email via its online portal <https://www.wattsau.com.au/support>.
- (b) If the Product is supplied by **Enware**, please complete the Product Service Request form (ENF091), which is available on request from our office (see contact details below), or online via <https://www.enware.com.au/warranty-service-form/>. All notifications and accompanying forms must be sent to Enware marked for the attention of Enware, 9 Endeavour Road, Caringbah NSW 2229. Enware can also be contacted by telephone (1300 369 273) or by email ([info@enware.com.au](mailto:info@enware.com.au)).

On receipt of a notification from you of a claim under this Warranty Statement, the relevant Supplier may contact you requesting you provide reasonably additional evidence, information or details about your claim, or requiring that the relevant Product should be returned to the Supplier (in accordance with the Supplier's instructions) for inspection and testing.

Your failure to comply with any such request within a reasonable amount of time may result in your claim under this Warranty Statement being rejected.

## 3. Our responsibilities

(a) In the event that the Supplier is reasonably satisfied that there is a defect in the relevant Product within the applicable Warranty Period, the Supplier will, at its option, replace the Product, supply an equivalent product or repair the Product, free of charge. Your costs in making a warranty claim under this Warranty Statement, including any costs in relation to freight, collection, delivery and installation, are to be borne and paid by you. However, if in respect of a Product, it is indicated in the Warranty Table that labour support will be provided, and the Supplier is reasonably satisfied that a defect in the Product takes place during the period that labour support will be provided as indicated in the Warranty Table, the Supplier will bear the costs for delivery, repair and installation of the replacement Product (as applicable).

(b) TO THE EXTENT PERMITTED BY LAW AND SUBJECT TO PARAGRAPH 4 BELOW AND THE OPERATION OF THE AUSTRALIAN CONSUMER LAW:

- (i) THE WARRANTY SET OUT IN THIS WARRANTY STATEMENT IS GIVEN EXPRESSLY AND IS THE ONLY WARRANTY GIVEN BY THE SUPPLIER WITH RESPECT TO THE RELEVANT PRODUCT;
- (ii) THE SUPPLIER MAKES NO OTHER WARRANTIES, EXPRESS OR IMPLIED;
- (iii) THE SUPPLIER HEREBY SPECIFICALLY DISCLAIMS ALL OTHER WARRANTIES, EXPRESS OR IMPLIED, INCLUDING BUT NOT LIMITED TO, THE IMPLIED WARRANTIES OF MERCHANTABILITY AND FITNESS FOR A PARTICULAR PURPOSE; AND
- (iv) THE REMEDY DESCRIBED IN THIS WARRANTY STATEMENT SHALL CONSTITUTE THE SOLE AND EXCLUSIVE REMEDY FOR BREACH OF WARRANTY, AND THE SUPPLIER SHALL NOT BE RESPONSIBLE FOR ANY INCIDENTAL, SPECIAL OR CONSEQUENTIAL DAMAGES, OR LOST PROFITS OR THE COST OF REPAIRING OR REPLACING OTHER PROPERTY WHICH IS DAMAGED IF THE PRODUCT DOES NOT WORK PROPERLY.

## 4. Australian Consumer Law

This paragraph 4 applies if you are a 'Consumer' (as defined in section 3 of the Australian Consumer Law (**ACL**)) and the Product or services supplied to you falls within the goods or services which, for the purposes of the ACL, are of a kind ordinarily acquired for personal, domestic or household use or consumption.

The Products and services provided by the Supplier come with guarantees that cannot be excluded under the ACL, and noting in this Warranty Statement should be interpreted as attempting to exclude, restrict or modify such guarantees or your rights under the ACL. For major failures with any services, you are entitled:

- (c) to cancel your service contract with us; and
- (d) to a refund for the unused portion, or to compensation for its reduced value.

You are also entitled to choose a refund or replacement for major failures with Products. If a failure with the Product or a service does not amount to a major failure, you are entitled to have the failure rectified in a reasonable time. If this is not done you are entitled to a refund for the Products and to cancel the contract for the service and obtain a refund of any unused portion. You are also entitled to be compensated for any other reasonably foreseeable loss or damage from a failure in the Products or service\*.

## 5. Warranty table

\*the applicable period commences on the date of delivery of the Product.

PRODUCT GROUP	PRODUCT SERIES CODES	WARRANTY PERIOD (YEARS)*	LABOUR SUPPORT (YEARS)
Commercial Lab and Gas Turrets	LCN/LC/LF	5	3



1300 369 273  
info@enware.com.au  
enware.com.au