

Leva: 80mm Sequential Basin Mixer - No Spout +/- 1/2 Turn Ceramic Disc

The Leva range combines outstanding quality with functional, sleek design. For easy palm and wrist activated tapware, the LEVA 80 series delivers an extensive choice with greater control, particularly for arthritis sufferers. The sequential lever turns progressively from “off” to “cold” to “mixed”. This enhances safety, reduces hot water consumption and potentially reduces risk of Legionella.

OPTIONS

“Range of Enware spouts, showers and grab rails available SPC201, SPC202, SPC203, SPC250, SPC120, SPC121

“LEV80306WSQ-250 - with SPC250 spout



KEY FEATURES

- Sequential Ceramic Disc Mixing Cartridge ensures ultimate control with cold start up and stop “Click” at off, Cold & Mixed positions
- Colour Indicators for Hot/ Warm, Cold and Off
- Adjustable wall flange with o-ring seal
- Compact design - 50mm in-wall depth
- Supplied with outlet point
- Spout sold separately

PRODUCT CODE

LEV80306XWSQ	LEVA 80MM INWALL SQ BASIN MIXER NO SPOUT
--------------	--



Due to ongoing Research and Development, specifications may change without notice.
Component specifications may change on some export models.
Refer to warranty statement for warranty details - www.enware.com.au/warranty.

TECHNICAL DATA

Finish	Chrome
Valve Type	Ceramic Disc
Minimum Working Temperature	5°C
Maximum Working Temperature	85°C
Minimum Recommended Pressure	50kPa
Maximum Recommended Pressure	500kPa
Minimum Working Pressure	50kPa
Maximum Working Pressure	500kPa
Maximum Static Pressure	800kPa
Primary Flow Rate	8L/min

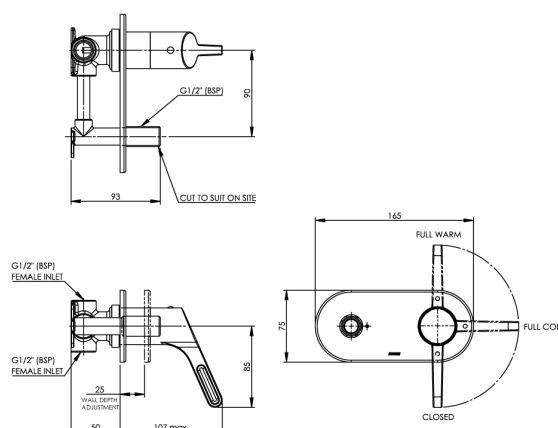

SPARE PARTS

LEVSQSBA-180	Spare Parts: Leva - Sequential - Cartridge Kit
WBSQSHSBA	Spare Parts: Wellbeing - Stuffing Box Assembly - SQ Shower Mixer - SQL 180

Version 02 July 2023

1300 369 273 | info@enware.com.au | enware.com.au

ENWARE
A WATTS Brand

Leva: 80mm Sequential Basin Mixer - No Spout †- †1/2 Turn Ceramic Disc