

Restore Pneumatic In-Wall Dual Flush Cistern with Low Profile Buttons Anti-Vandal Plate 4.5/3L

RH-CIS4 is a highly vandal resistant toilet pan flushing option for in-wall, in-duct or in-ceiling installation. With a space saving cistern slim enough to fit between 410mm studs in a true 85mm cavity, the 4.5/3L dual-flush concealed cistern is both WELS and WaterMark approved and is ideal for pairing with any vandal resistant Solid Surface wall-faced toilet pan. The cistern tank can be mounted in-ceiling or reverse mounted for service through a service duct or a service opening to the rear of the pan. All serviceable parts on the cistern are of the highest quality and are accessible through the service panel on the tank itself. Included is a pre-fitted pneumatic lifter and hose (1.3m) for remote dual-flush, pneumatic actuation via anti-vandal S.S. buttons. The one-piece moulded cistern tank carries a 15-year warranty and is manufactured of leak-proof high-density polyethylene for high impact resistance.

KEY FEATURES

- Highly vandal resistant WC flushing option
- Perfectly suited to Solid Surface toilet pans
- Ultra slim tank - 80mm
- Operating Pressure: 10-1000 kPa
- Pneumatic remote actuator plate
- Stainless Steel backing plate and buttons
- Choice of 6/3 or 4.5/3 Litre flushing capacities for toilets
- Flexible cistern and actuator installation possibilities
- WELS and WaterMark certified
- Ideal for public amenities in high-risk areas where security is required



PRODUCT CODE

RH-CIS4

Restore Pneumatic In-Wall Dual Flush
Cistern with Low Profile Buttons Anti-Vandal
Plate 4.5/3L



Due to ongoing Research and Development, specifications may change without notice.

Component specifications may change on some export models.

Refer to warranty statement for warranty details - www.enware.com.au/warranty.

Products are to be installed in accordance with the Plumbing Code of Australia and AS/NZS3500.

Reference should also be made to the Australasian Health Facility Guidelines (AHFG), ABCB and Local Government regulations when considering the choice of, and the installation of these products.

Restore Pneumatic In-Wall Dual Flush Cistern with Low Profile Buttons Anti-Vandal Plate 4.5/3L

TECHNICAL DATA

WELS Category	Lavatory
Standard WELS	4Stars
WELS Full Flush Volume	4.5L
WELS Half Flush Volume	3L
WELS Average Flush Volume	3.4L
Inlet Connection	15mm (1/2" BSP)

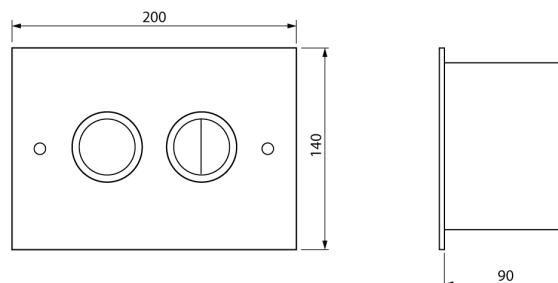

The Remote-Flush concealed cistern allows for great flexibility in the positioning of the pneumatic actuators and cistern. The cistern can be installed elevated and to a maximum of 400mm either side from the toilet pan centre line. The following examples outline the possibilities of cistern and actuator installation.

PLEASE READ: Actuator Buttons cannot be installed directly in front of the Cisterns Service Access Point. A Panel is provided to cover the opening and allow access.

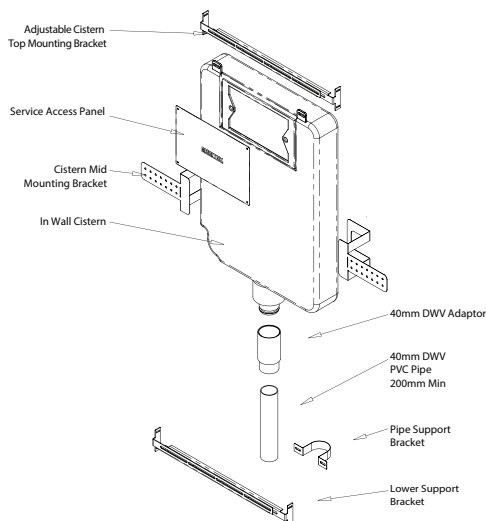

Fig 1: Exploded diagram

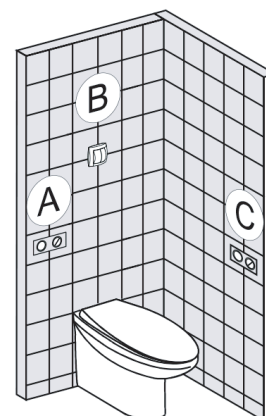

Fig 2: Possible actuator install points