

Delabie Tempostop Shower Valve - Recess Lead Free

The Tempostop shower valve when operated provides a 30 second* automatic shut-off with an easy push button activation. Designed to comply with intensive use in public areas with a high resistance to vandalism.

KEY FEATURES

- Easy push button activation
- Automatic shut-off after 30 seconds*
- Cover plate is without exposed screws providing a high resistance to vandalism
- Lead-free brass (not required for shower installations)

* Times are indicative only and may vary depending on the water supply pressure and flow conditions

Note: this product should be installed to allow removal for maintenance/ replacement.



PRODUCT CODE

TFC749128

Delabie Tempostop Shower Valve - Recess
Lead Free



Delabie Tempostop Shower Valve - Recess Lead Free

TECHNICAL DATA

Working Pressure Range	100 - 500 kPa
Recommended Pressure	250 - 300 kPa
Maximum Static Pressure	1000 kPa
Maximum Water Temperature	70°C
Operating Force @ 300kPa	47N
Inlet / Outlet Connections	1/2" BSP (15mm)
Valve Type	Time Flow

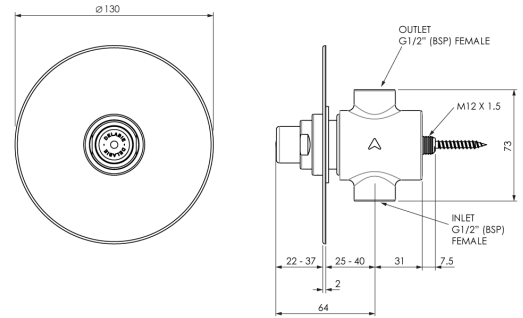

SPARE PARTS

TFCS743428	Cartridge Replacement 30 sec
TFCS743002	TempoStop Colour Indicator - Red
672713	Dome
TFC649S	Shower Face Plate Suit TFC749128 Recess
671701	Locking Ring

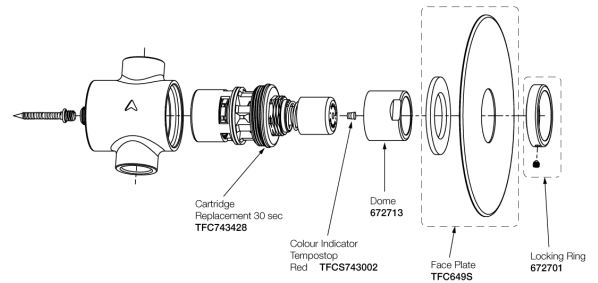

Products are to be installed in accordance with the Plumbing Code of Australia and AS/NZS3500. Reference should also be made to the Australasian Health Facility Guidelines (AHFG), ABCB and Local Government regulations when considering the choice of, and the installation of these products. Due to ongoing Research and Development, specifications may change without notice. Component specifications may change on some export models. Refer to warranty statement for warranty details - www.enware.com.au/warranty.