

# Key Operated Hose Tap FI Extended with Non-Return Valve and Key Handle - Jumper Valve

Provides control over water systems exposed to the public by using a removable key when isolating or adjusting the valve. The key operated vandal resistant range is made from dezincification resistant (DR) brass with durable chrome plated finish.

## KEY FEATURES

- Removable key handle protects against unauthorised use and water wastage
- Jumper valve
- Integral dual check valve at inlet
- Includes key handle (rough brass finish)
- 1/2" BSP female inlet, 3/4" BSP outlet connection
- High quality construction with durable chrome plating
- Serviceable with all wearing components replaceable, thus providing an even longer life

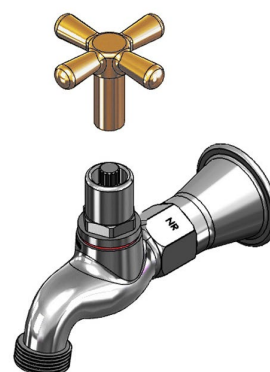

## PRODUCT CODE

VP350FDC

Key Operated Hose Tap FI Extended with Non-Return Valve and Key Handle - Jumper Valve

LEAD  
FREE

Products are to be installed in accordance with the Plumbing Code of Australia and AS/NZS3500. Reference should also be made to the Australasian Health Facility Guidelines (AHFG), ABCB and Local Government regulations when considering the choice of, and the installation of these products.

Due to ongoing Research and Development, specifications may change without notice. Component specifications may change on some export models.

Refer to warranty statement for warranty details - [www.enware.com.au/warranty](http://www.enware.com.au/warranty).

## TECHNICAL DATA

Inlet Connection	1/2" BSP (15mm) FI
Outlet Connection	3/4" BSP (20mm)
Recommended Pressure	50kPa – 500kPa
Maximum Static Pressure	1200kPa
Maximum Jumper Valve Working Temperature	95°C
Finish	Chrome
Valve Type	Jumper Valve

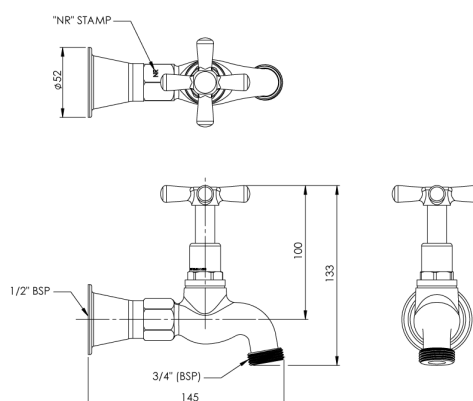

## SPARE PARTS

RB356	Key Handle Only (Rough Brass Finish) for Key Operated Hose Tap
-------	--

Version 08 January 2026

1300 369 273 | [info@enware.com.au](mailto:info@enware.com.au) | [enware.com.au](http://enware.com.au)

**ENWARE**  
A WATTS Brand