

# Spare Parts: School Pattern - Stuffing Box Assembly - Recess - 1/2 Turn Ceramic Disc - 15mm Extended

School Pattern Recess Stuffing Box Assembly Extended  
- 1/2 Turn Ceramic Disc 15mm Extended

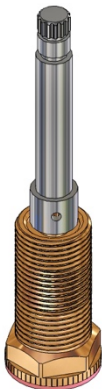

### PRODUCT CODE

|        |                         |
|--------|-------------------------|
| VPQ383 | VPQ 15MM EXT RECESS SBA |
|--------|-------------------------|



Due to ongoing Research and Development, specifications may change without notice.  
Component specifications may change on some export models.  
Refer to warranty statement for warranty details - [www.enware.com.au/warranty](http://www.enware.com.au/warranty).

### TECHNICAL DATA

|  |              |
|--|--------------|
| Finish                                     | Chrome       |
| Valve Type                                 | Ceramic Disc |
| Maximum Ceramic Disk Operating Temperature | 85°C         |
| Maximum Jumper Valve Working Temperature   | 95°C         |
| Maximum Working Pressure                   | 500kPa       |

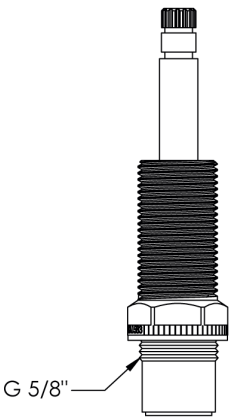

### SPARE PARTS

|        |  |
|--------|--|
| VPQ383 | Spare Parts: School Pattern - Stuffing Box Assembly - Recess - 1/2 Turn Ceramic Disc - 15mm Extended |
|--------|--|