

Wellbeing Clinical Wash Basin 600mm

Purpose-built to meet the stringent requirements of the Australasian Health Facility Guidelines (AusHFG) for Type B Clinical Basins, the Wellbeing Clinical 600mm Wall Hung Hand Wash Basin by Enware is engineered for superior hygiene, functionality, and safety.

This premium basin incorporates exclusive Enware design innovations to support best-practice infection control in clinical environments. Key features include a precision water-channelling blade, anti-splash rim, and offset drain position (Australian Registered Design No. 202518915 and Patent Pending). Together, these elements minimise splash risk and promote efficient, hygienic water drainage.

Manufactured from durable vitreous china and fully glazed—including Enware's ProteX Plus™ antibacterial nano-glaze for durability and an easy-to-clean surface—this basin enhances hygiene and simplifies maintenance. An optional shroud is available, supporting both visual integration and compliance with AusHFG recommendations for health facilities.

Versatile and compliant, the Wellbeing Clinical Basin is ideal for use in healthcare, commercial, and aged care environments, and is suitable for installations meeting AS1428.1 accessibility standards.



Basin shown with optional shroud

PRODUCT CODES

WB-BSNTYPB-E00	No Taphole No Overflow
WB-BSNTYPB-E11	1 x Taphole 1 x Overflow
WB-BSNTYPB-E10	1 x Taphole No Overflow

KEY FEATURES

- AusHFG Type B Clinical Basin Compliant
- 600mm wide durable white vitreous china basin
- Fully glazed under and over preventing bacteria growth
- Wall hung design
- Australian Registered Design No. 202518915 and Patent Pending
 - Water-channelling blade: Directs water flow efficiently to reduce pooling
 - Anti-splash rim: Minimizes water splashing for improved infection control
 - Offset drain (AusHFG preferred): Reduces contamination risk
- Enware's ProteX Plus™ antibacterial nano-glaze for durability and easy cleaning
- Waste and mounting bolts included
- Satisfies AS1428.1:2021 requirements
- Optional shroud available
- Enhances visual appeal and ensures compliance with AusHFG shroud requirements.
- Suitable for commercial, healthcare, and aged care settings.
- Offered in no tap hole or one tap hole versions to accommodate different environments
- Available with or without overflow to suit specific installation needs.



Due to ongoing Research and Development, specifications may change without notice. Component specifications may change on some export models.

Refer to warranty statement for warranty details - www.enware.com.au/warranty.

Products are to be installed in accordance with the Plumbing Code of Australia and AS/NZS3500. Reference should also be made to the Australasian Health Facility Guidelines (AHFG), ABCB and Local Government regulations when considering the choice of, and the installation of these products.

Wellbeing Clinical Wash Basin 600mm

TECHNICAL DATA



Basin shown with optional shroud

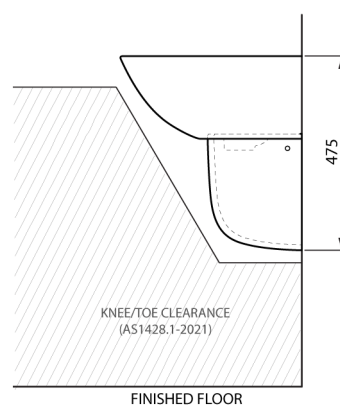
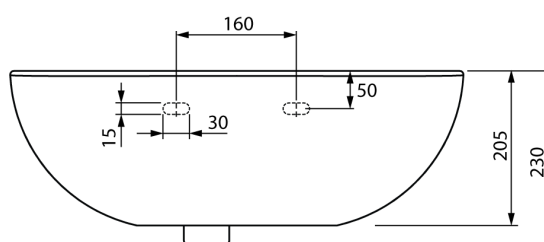
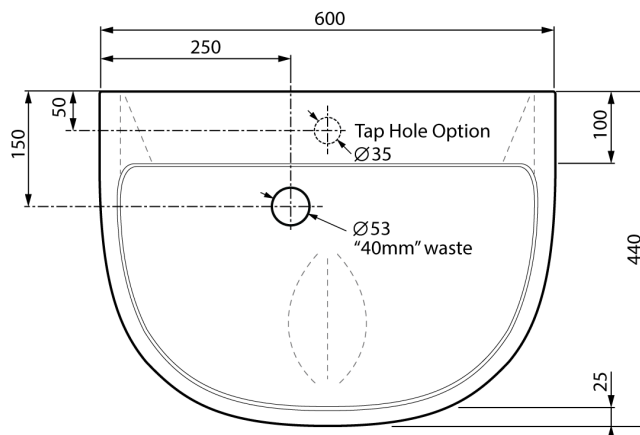

WB-BSNTYPB-E basin with WB-SHRD-E600 shroud

OPTIONAL ACCESSORIES

WB-SHRD-E600	Wellbeing: Vitreous China Shroud suits 600mm Type B Basins
WBS-S019	Standard P-Trap - 40mm
WBS-S007	Short P-Trap - 40mm
WB-BSNBT-CB	Bottle Trap Chrome 40mm