

# Custodian: WC Flush Valve Assembly - 20mm 12 VDC

Enware Custodian WC Dual Flush Solenoid for Smartflow WMS. Piezo operated Stainless Steel 12V Solenoid includes airbreak, isolation, in-line filter and 25mm inlet connection. For use with Custodian piezo operated flush panels. Note: Must be used in conjunction with Custodian Smartboard

## KEY FEATURES

- Stainless steel solenoid isolation with integrated in-line filter
- Suitable for Water Management Systems

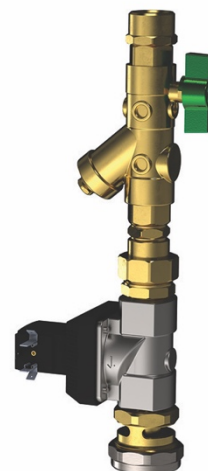

## PRODUCT CODE

WMS8312

CUSTODIAN 20MM SS 12VDC FLUSH ASSEM



Due to ongoing Research and Development, specifications may change without notice.  
Component specifications may change on some export models.  
Refer to warranty statement for warranty details - [www.enware.com.au/warranty](http://www.enware.com.au/warranty).

## TECHNICAL DATA

WELS Category	Urinal
Standard WELS	3Stars
Standard WELS Flow Rate	4L/min
Minimum Dynamic Pressure to achieve WELS Flush Volume	300kPa
Water Supply Line Size	1"[25mm] copper pipe
Minimum Working Pressure	200kPa
Inlet Connection	1"BSP
Outlet Connection	1 1/2"BSP
Flush Pipe	1 1/2" (40mm) flush pipe is required below the air break. (Note: use a maximum of 1 x 90° bend in flush pipe. If an offset is required, 2 x 45° bends must be used. Maximum of 1 offset per flush pipe. Air break must be installed in a vertical position at 700mm +/- 100 mm above the pan inlet.
Operating Voltage	12V
Operating Voltage	DCAC/DC
Kv Factor	8.3m3/h

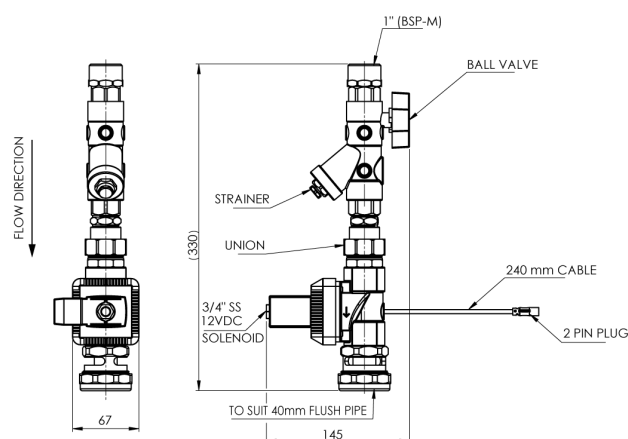

## Custodian: WC Flush Valve Assembly - 20mm 12 VDC

### SPARE PARTS

EMFS305	Spare Parts: Y-Strainer - Ball Valve 3/4"BSP F-F
EMFS306	Spare Parts: Olive Rubber Suit 40Mm Flush Pipe Emf